

## Distribution box dispenser inputs/outputs

Part number 90.74.910E

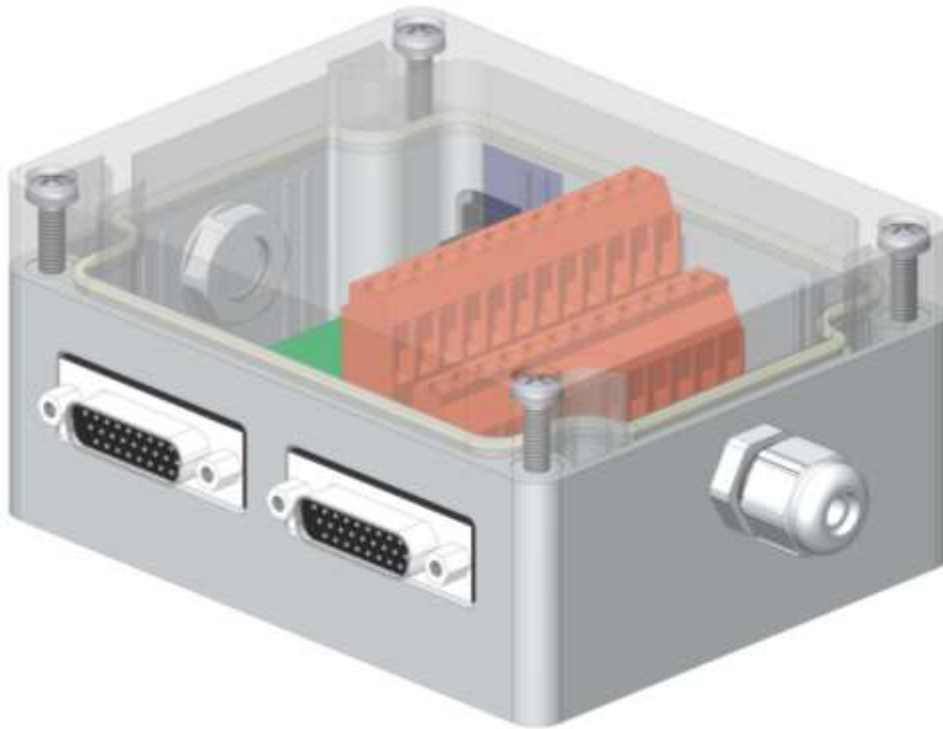

### Use

The optional distribution box offers the possibility to connect simultaneously up to two completely assembled Valentin components e.g. signal lamp (part number 90.74.920) and product sensor (part number 90.52.796) with the inputs/outputs of the printing system. Furthermore by an additional cable gland individual lines can be led to a screw terminal and therefore further customized components can be attached.

### Installation

The installation is effected directly at the optional carrier plate extension (part number 90.74.906) of ILX or in any place in the environment dependent on the length of connecting cable.

### Connection

The connection is effected at the existing 26 pin D-SUB socket of inputs/outputs of ILX V.

## Dimensions distribution box

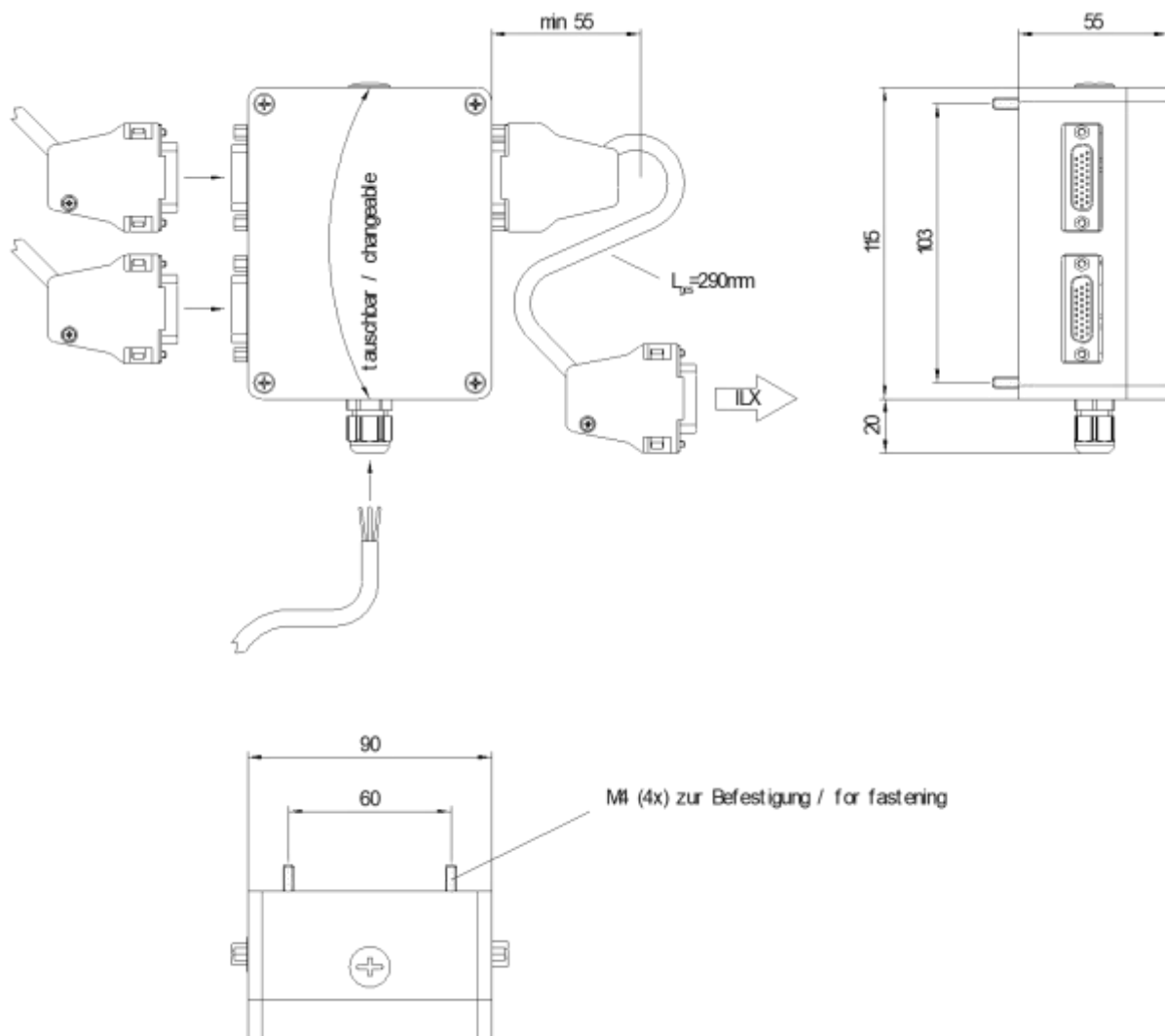

## Dimensions when installing at the carrier plate extension

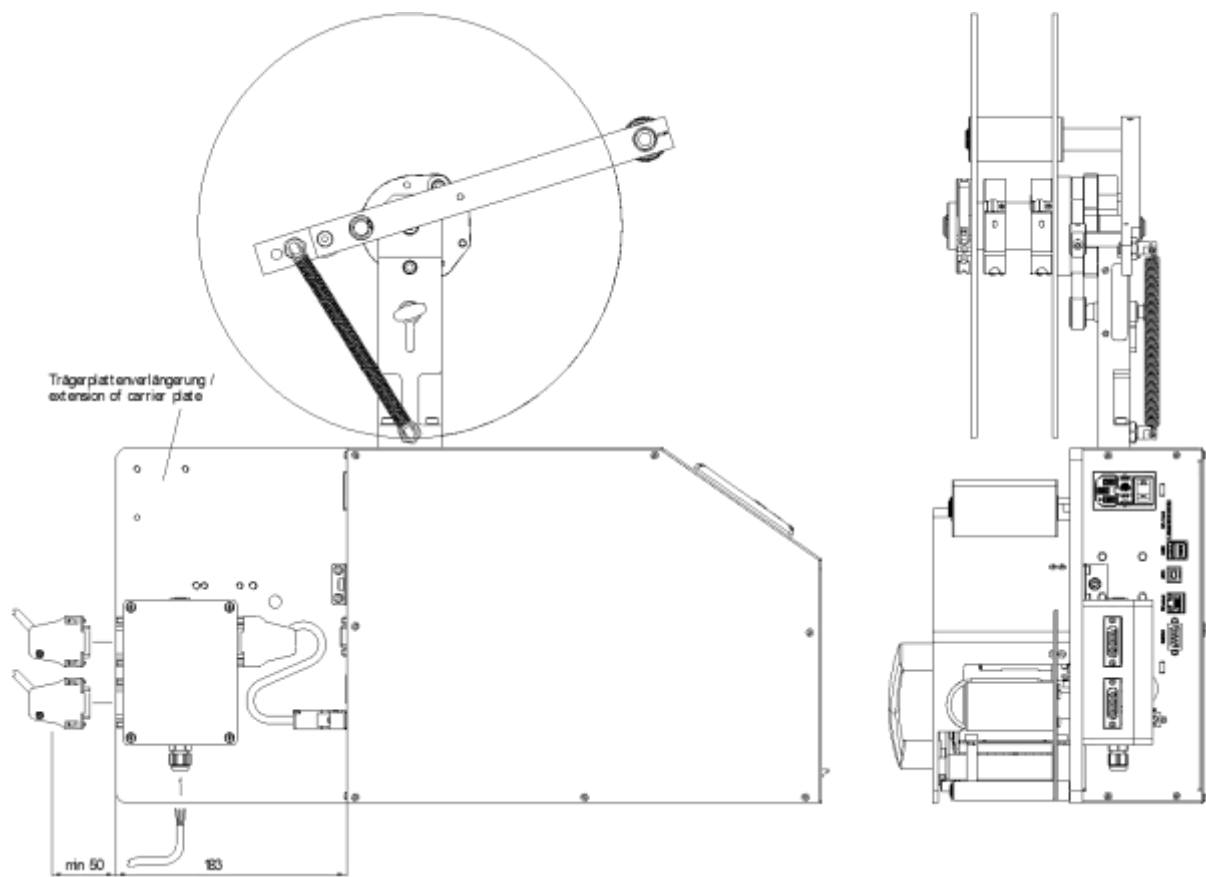

## Assignment of the screw clips

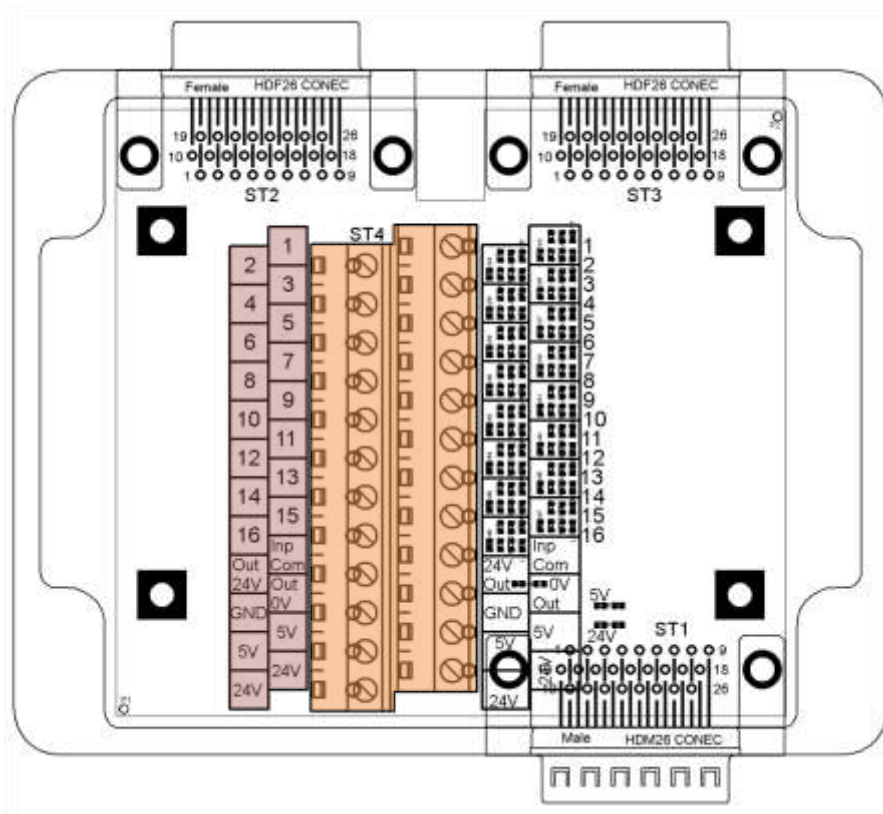

Name	Clip	Clip	Name
Port 2	2	1	Port 1
Port 4	4	3	Port 3
Port 6	6	5	Port 5
Port 8	8	7	Port 7
Port 10	10	9	Port 9
Port 12	12	11	Port 11
Port 14	14	13	Port 13
Port 16	16	15	Port 15
VDC for Outputs	18	17	COM / VDC for Inputs
GND	20	19	COM for Outputs
+5 V	22	21	+5 V
+24 V	24	23	+24 V

## **Connection of sensors / switches**

The wiring is described in the operating manual of the printing system. The signal names correspond to the names in the operating manual of the printing system.

## **Necessary wiring of voltage supply**

### **Connection with power supply by the printer**

If the voltage supply provided by the printer (+24 V, +5 V) is used, the following jumpers are to be used:

Clip 17 - Clip 20

Clip 19 - Clip 20

Clip 18 - Clip 23

### **Connection with external power supply**

If an external voltage source is used (e.g. SPS), the voltage supply is to be attached as following:

GND<sub>ext</sub> - Clip 17

GND<sub>ext</sub> - Clip 19

VDC<sub>ext</sub> - Clip 18 (+5 V .. + 24 V)

## Examples

### Connection of a switch

At voltage supply by the printer, a switch/sensor e.g. for the 'print start' signal (Port 1) is attached as following.

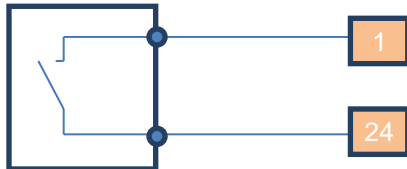

### Connection of a switch

At external voltage supply, a switch/sensor e.g. for the 'print start' signal (Port 1) is attached as following.

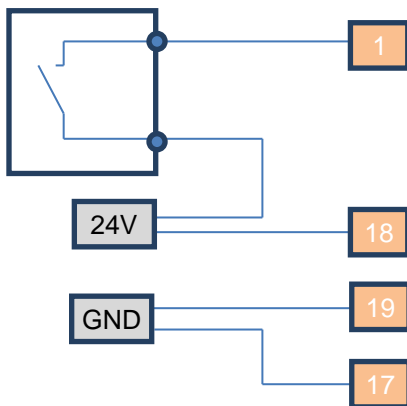

### Connection of a signal lamp

At voltage supply by the printer, a signal lamp for the status 'ready' is attached as following.

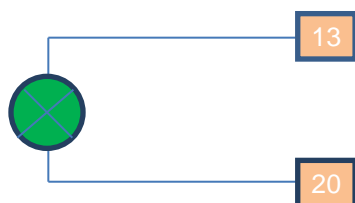

### Connection of a signal lamp

At external voltage supply, a signal lamp for the status 'ready' is attached as following.

