

## VITA V

Service Instructions



**Edition:** 04/23

### **Copyright**

Copyright by Carl Valentin GmbH

Subject to modifications.

All rights, including those regarding the translation, are reserved.

No part of this document may be reproduced in any form (print, photocopy, or any other method) or edited, copied, or distributed electronically without written permission from Carl Valentin GmbH.

### **Trademarks**

All named brands or trademarks are registered brands or registered trademarks of their respective owners and may not be separately labelled. It must not be concluded from the missing labelling that it is not a registered brand or a registered trademark.

### **Topicality**

Information on the scope of delivery, appearance, performance, dimensions, and weight reflect our knowledge at the time of printing.

Due to constant further development of our products discrepancies between documentation and product can occur.

Please check [www.carl-valentin.de](http://www.carl-valentin.de) for the latest update.

### **Terms and Conditions**

Deliveries and services are effected under the General Conditions of Business of Carl Valentin GmbH

### **Licences**

**CE**    Low-Voltage Directive (2014/35/EU)  
         Electromagnetic Compatibility Directive (2014/30/EU)  
         RoHS Directive (2011/65/EU)



### **Carl Valentin GmbH**

Postfach 3744  
78026 Villingen-Schwenningen  
Neckarstraße 78 – 86 u. 94  
78056 Villingen-Schwenningen

Phone    +49 7720 9712-0  
Fax       +49 7720 9712-9901

E-Mail    [info@carl-valentin.de](mailto:info@carl-valentin.de)  
Internet   [www.carl-valentin.de](http://www.carl-valentin.de)

## Table of Contents

<b>1</b>	<b>Notes on this Document .....</b>	<b>5</b>
1.1	User Notes.....	5
1.2	Instructions .....	5
1.3	Cross References.....	6
<b>2</b>	<b>Safety Instructions .....</b>	<b>7</b>
2.1	General Safety Instructions .....	7
2.2	Safety Handling when Working with Electricity .....	9
<b>3</b>	<b>Connector Pin Assignment (Printer Rear) .....</b>	<b>11</b>
<b>4</b>	<b>Cleaning .....</b>	<b>13</b>
4.1	General Cleaning.....	14
4.2	Clean the Transfer Ribbon Drawing Roller .....	14
4.3	Clean the Pressure Roller .....	15
4.4	Clean the Printhead.....	16
4.5	Clean the Label Photocell .....	17
<b>5</b>	<b>Replacing Components .....</b>	<b>19</b>
5.1	Tool list .....	19
5.2	Replace the Printhead .....	20
5.3	Adjust the Print Position .....	22
5.4	Replace the Pressure Roller .....	23
5.5	Replace the Label Photocell.....	24
5.6	Replace the CPU PCB .....	25
5.7	Replace the Power Supply .....	26
5.8	Replace the Battery .....	27
<b>6</b>	<b>Adjustments, Settings and Alignments .....</b>	<b>29</b>
6.1	Adjust the Print Mechanism.....	29
6.2	Adjust the Printhead .....	29
6.3	Adjust the Transfer Ribbon Feed Path.....	32
6.4	Adjust the Ribbon Rewinder/Unwinder.....	33
6.5	Adjust the Head Switch .....	34
6.6	Oil and Lubricate .....	35
<b>7</b>	<b>Retrofit with Options .....</b>	<b>37</b>
7.1	I/O Plate.....	37
7.2	Dispenser Unit.....	38
7.3	Cutter Unit .....	39
<b>8</b>	<b>Error Correction.....</b>	<b>41</b>
<b>9</b>	<b>Control Inputs and Outputs.....</b>	<b>51</b>
<b>10</b>	<b>Connection Plans .....</b>	<b>59</b>
10.1	Wiring Plan .....	59
10.2	CPU Component Placement Specification.....	60
<b>11</b>	<b>Environmentally-Friendly Disposal .....</b>	<b>61</b>
<b>12</b>	<b>Index .....</b>	<b>63</b>



# 1 Notes on this Document

## 1.1 User Notes

This service manual is intended for qualified service and maintenance staff.

This manual contains information about the electronics and the mechanical part of the printing system.

Information about operation of printer can be taken from our operating manual.

If a problem arises that cannot be solved with help of this service of manual, then please contact your responsible dealer.

## 1.2 Instructions

Basic information and warning references with the corresponding signal words for the danger level are as follows specified in this manual:



**DANGER** identifies an extraordinarily great and immediate danger which could lead to serious injury or even death.



**WARNING** identifies a possible danger could lead to serious bodily injury or even death if sufficient precautions are not taken.



**WARNING** of cutting injuries.

Pay attention that cutting injuries caused by blades, cutting devices or sharp-edged parts are avoided.



**WARNING** of hand injuries.

Pay attention that hand injuries caused by closing mechanical parts of a machine/equipment are avoided.



**WARNING** of hot surfaces.

Pay attention so as not to come into contact with hot surfaces.



**CAUTION** indicates a potentially dangerous situation which could lead to moderate or light bodily injury or damage to property.



**NOTICE** gives you tips. They make a working sequence easier or draw attention to important working processes.



Gives you tips on protecting the environment.



Handling instruction



Optional accessories, special fittings

Date

Information in the display

### 1.3 Cross References

**Drawings**

References to specific items in a figure are marked with letters. They are identified with parentheses in the text, e.g. (A). If no figure number is provided, letters in the text always refer to the graphic directly above the text. If a reference is made to another graphic, the figure number is specified, e.g. (A, in figure 5).

**Cross references to chapters and sections**

For a cross reference to chapters and sections, the chapter number and page number are specified, e.g. a reference to this section: see chapter 1.3.2, page 35).

**References to other documents**

References to other documents have the following form: See '*operating manual*'.

## 2 Safety Instructions

### 2.1 General Safety Instructions

#### Workplace and method of working

- ⇒ Keep the area around the device clean during and after maintenance.
- ⇒ Work in a safety-conscious manner.
- ⇒ Store dismantled device parts in a safe place while maintenance is being performed.

#### Clothing



##### CAUTION!

The drawing in of items of clothing by moving parts can lead to injuries.

- ⇒ If possible, do not wear clothing which could be caught by moving device parts.
- ⇒ Button or roll up shirt or jacket sleeves.
- ⇒ Tie or pin up long hair.
- ⇒ Tuck the ends of scarves, ties and shawls into your clothing or secure them with non-conductive clips.



##### DANGER!

Risk of death from increased flow of current via metals parts which come into contact with the device.

- ⇒ Do not wear clothing with metal parts.
- ⇒ Do not wear jewellery.
- ⇒ Do not wear glasses with a metal frame.

#### Protective clothing

If a possible danger to your eyes is present, wear protective goggles, especially in the following cases:

- when knocking in or knocking out pins and similar parts with a hammer
- when using spring hooks
- when loosening or inserting springs, snap rings and gripping rings
- when soldering
- when using solvents, cleaning agents or other chemicals

**Protective equipment****WARNING!**

Risk of injury in case of missing or faulty protective equipment.

- ⇒ After performing maintenance work, attach all safety equipment (covers, safety precautions, ground cables etc.).
- ⇒ Replace faulty parts and those which have become unusable.

**General safety instructions**

The printer is designed for power supply systems from 100 ... 240 V AC. Connect the label printer only to electrical outlets with a ground contact.

Couple the label printer to devices using extra low voltage only.

Before making or undoing connections, switch off all devices involved (computer, printer, accessories etc.).

Operate the label printer in a dry environment only and do not get it wet (sprayed water, mist etc.).

Maintenance and servicing work can only be carried out by trained personnel.

Operating personnel must be trained by the operator on the basis of the operating manual.

If the label printer is operated with the cover open, ensure that clothing, hair, jewellery and similar personal items do not contact the exposed rotating parts.

The print unit and parts of it (e.g. printhead) can get hot during printing. Do not touch the printhead during operation. Cool down the print unit before changing material, removal or adjustment.

Never use highly inflammable consumables.

There is a risk of injury at the tear-off edge. If the tear-off edge is not used, attach the edge protection profile.

Carry out only the actions described in these operating instructions. Any work beyond this may only be performed by the manufacturer or upon agreement with the manufacturer.

Unauthorized interference with electronic modules or their software can cause malfunctions.

Other unauthorized work or modifications to the direct print module can endanger operational safety.

Always have service work done in a qualified workshop, where the personnel have the technical knowledge and tools required to do the necessary work.



There are warning stickers on the direct print modules that draw your attention to dangers. Therefore the warning stickers are not to be removed as then you and others cannot be aware of dangers and may be injured.



### **DANGER!**

Danger to life and limb from power supply!

⇒ Do not open the casing.

## **2.2 Safety Handling when Working with Electricity**

### **Qualifications of personnel**

- ⇒ The following work may only be performed by instructed and trained electricians:
- work on the electrical assemblies
  - work on the device while it is open and connected to the power supply.

### **General precautions to be heeded when beginning maintenance**

- ⇒ Locate the emergency-stop or power switch so that it can be actuated in case of an emergency.
- ⇒ Unplug the device from the electrical outlet before performing the following work:
- removing or installing power supply units
  - working in the immediate vicinity of exposed power supply parts
  - mechanical inspection of power supply parts
  - modifying the device circuits.
- ⇒ Ensure that the device is de-energized.
- ⇒ Check the workplace for possible sources of danger, e.g. moist floors, defective extension cables, faulty protective conduction connections.

### **Additional precautions to be heeded for devices with exposed energized parts**

- ⇒ Give another person the task of remaining near the workplace. This person must be familiar with the location and operation of the emergency-stop and power switches and switch off the power if danger arises.
- ⇒ Use only one hand while working on electrical circuits when a device is switched on. Hold the other hand behind your back or put it in your jacket pocket. This prevents the electricity from flowing through your body.

### **Tools**

- ⇒ Do not use worn or damaged tools.
- ⇒ Use only tools and testing equipment that is suitable for the respective task.

**What to do in case an accident occurs**

- ⇒ Proceed in a very cautious and calm manner.
- ⇒ Avoid endangering yourself.
- ⇒ Switch the power off.
- ⇒ Request medical help (emergency physician).
- ⇒ Call for first aid if necessary.

### 3 Connector Pin Assignment (Printer Rear)

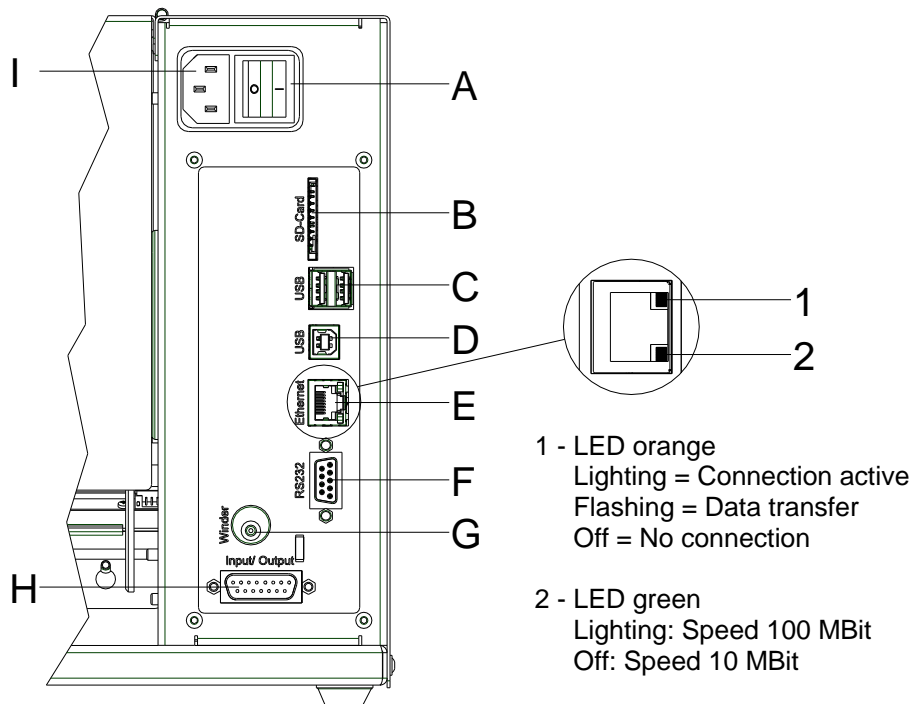

**Figure 1**

- A Switch On/Off
- B Plug-in for SD card
- C 2 x USB host
- D USB 2.0 Hi-Speed Device (for connection PC)
- E Ethernet 10/100 interface
- F Serial interface RS-232
- G Winder connection



**CAUTION!**

The label printer can be damaged by non-compliant winders.

⇒ Attach only winders of Carl Valentin.

- H External output/input (option)
- I Power supply



## 4 Cleaning



### DANGER!

Risk of death via electric shock!

⇒ Before opening the housing cover, disconnect the label printer from the mains supply and wait for a moment until the power supply unit has discharged.



### NOTICE!

When cleaning the label printer, personal protective equipment such as safety goggles and gloves are recommended.

### Cleaning plan

Task	Frequency
General cleaning (see chapter 4.1, on page 14).	As necessary.
Clean the transfer ribbon drawing roller (see section 4.2, page 15).	Each time the transfer ribbon is changed or when the printout is adversely affected.
Clean the print roller (see chapter 4.3, on page 15).	Each time the label roller is changed or when the printout and label transport are adversely affected.
Clean the printhead (see chapter 4.4, on page 16).	<b>Direct thermal printing:</b> Each time the label roller is changed. <b>Thermal transfer printing:</b> Each time the transfer ribbon is changed or when the printout is adversely affected.
Clean the label photocell (see chapter 4.5, on page 17).	When the label roller is changed.



### WARNING!

Risk of fire by easily inflammable label soluble!

⇒ When using label soluble, dust must be completely removed from the label printer and cleaned.

## 4.1 General Cleaning



### CAUTION!

Abrasive cleaning agents can damage the label printer!

- ⇒ Do not use abrasives or solvents to clean the outer surface of the label printer.
- ⇒ Remove dust and paper fuzz in the printing area with a soft brush or vacuum cleaner.
- ⇒ Clean the outer surfaces with an all-purpose cleaner.

## 4.2 Clean the Transfer Ribbon Drawing Roller

A soiled drawing roller can lead to reduced print quality and can affect transport of material.

1. Open the printer cover.
2. Turn the lever (A, Figure 2) counter clockwise to lift up the printhead (B, Figure 2).
3. Remove labels and transfer ribbon from the label printer.
4. Remove deposits with the roller cleaner and a soft cloth.
5. Turn the roller (D, Figure 2) manually step by step to clean the complete roller (only possible when the printer is switched off, as otherwise the step motor is full of power and the roller is kept in its position).
6. Reload labels and transfer ribbon.
7. To move the printhead (B, Figure 2) down, turn the pressure lever (A, Figure 2) in clockwise direction until it locks.
8. Close the printer cover.

### 4.3 Clean the Pressure Roller

A soiled pressure roller can lead to reduced print quality and can affect transport of material.



#### CAUTION!

Pressure roller can be damaged!

⇒ Do not use sharp or hard objects to clean the pressure roller.

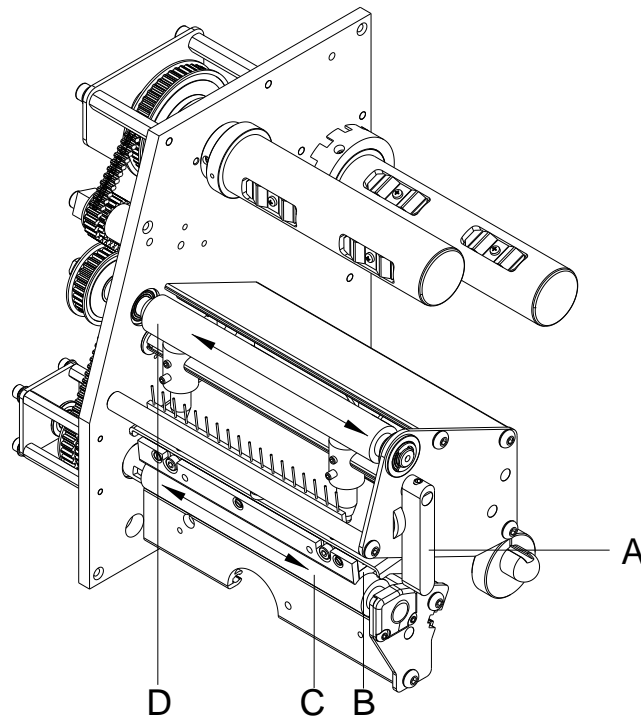

Figure 2

1. Open the printer cover.
2. Turn the lever (A) counter clockwise to lift up the printhead (B).
3. Remove labels and transfer ribbon from the label printer.
4. Remove deposits with the roller cleaner and a soft cloth.
5. Turn the roller (C) manually step by step to clean the complete roller (only possible when the printer is switched off, as otherwise the step motor is full of power and the roller is kept in its position).
6. Insert again the transfer ribbon material.
7. To move the printhead down, turn the pressure lever (A) in clockwise direction until it locks.
8. Close the printer cover.

## 4.4 Clean the Printhead

Printing can cause accumulation of dirt at printhead e.g. by colour particles of transfer ribbon, and therefore it is necessary to clean the printhead in regular periods depending on operating hours, environmental effects such as dust etc.



### CAUTION!

Printhead can be damaged!

- ⇒ Do not use sharp or hard objects to clean the printhead.
- ⇒ Do not touch the protective glass layer of the printhead.

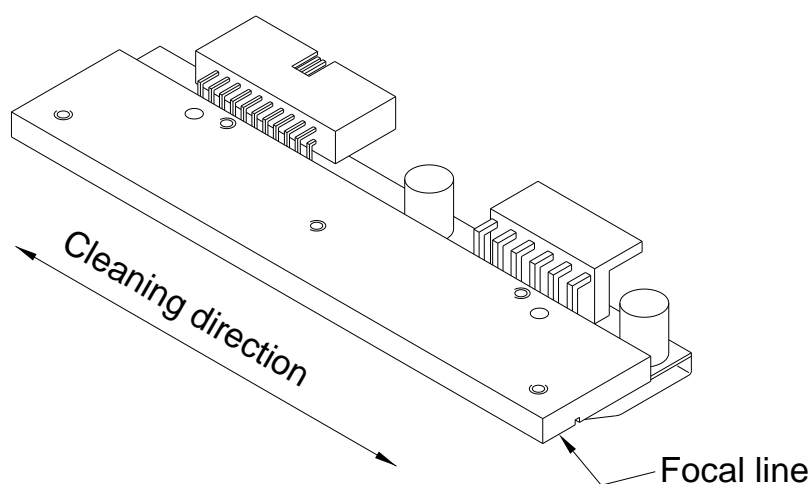

**Figure 3**

1. Open the printer cover.
2. Turn the lever (A, in Figure 2) counter clockwise to lift up the printhead.
3. Remove labels and transfer ribbon from the label printer.
4. Clean the printhead surface with a special cleaning pen or a cotton swab dipped in pure alcohol.
5. Before using the label printer, let the printhead dry for about two to three minutes.
6. Insert again the transfer ribbon material.
7. To move the printhead down, turn the pressure lever (A, Figure 2) in clockwise direction until it locks.
8. Close the printer cover.



## 4.5 Clean the Label Photocell



### CAUTION!

Label photocell can be damaged!

⇒ Do not use sharp or hard objects or solvents to clean the label photocell.

The label photocell can be soiled with paper dust. This may affect the label scanning.

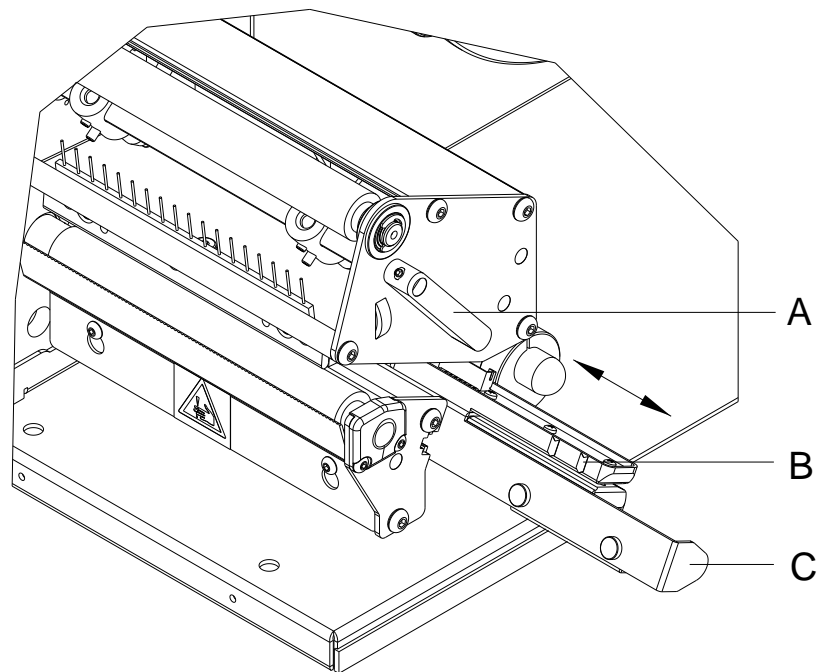

**Figure 4**

1. Open the printer cover.
2. Turn the lever (A) counter clockwise to lift up the printhead.
3. Remove labels and transfer ribbon from the label printer.
4. Pull the label photocell slowly outwards via the tab (C). Ensure that the label photocell cable is not tensioned by this.
5. Clean the label photocell and sensor units (B) with a brush or cotton swab soaked in pure alcohol.
6. Push the label photocell back via tab (C) and set it.
7. Reload labels and transfer ribbon.
8. To move the printhead down, turn the pressure lever (A) in clockwise direction until it locks.
9. Close the printer cover.



## 5 Replacing Components



### **DANGER!**

Risk of death via electric shock!

⇒ Before opening the housing cover, disconnect the label printer from the mains supply and wait for a moment until the power supply unit has discharged.

### 5.1 Tool list

Some service work requires the following tools:

- Philips-head screwdriver, size 1
- Hexagonal wrench 1.5 mm
- Hexagonal wrench 2.5 mm
- Spring scale 10 N
- Spring scale 25 N

## 5.2 Replace the Printhead



### CAUTION!

The printhead can be damaged by static electricity discharges and impacts!

- ⇒ Set up the printer on a grounded, conductive surface.
- ⇒ Ground your body, e.g. by wearing a grounded wristband.
- ⇒ Do not touch the contacts on the plug connections (B, C).
- ⇒ Do not touch the printing line (E) with hard objects or your hands.

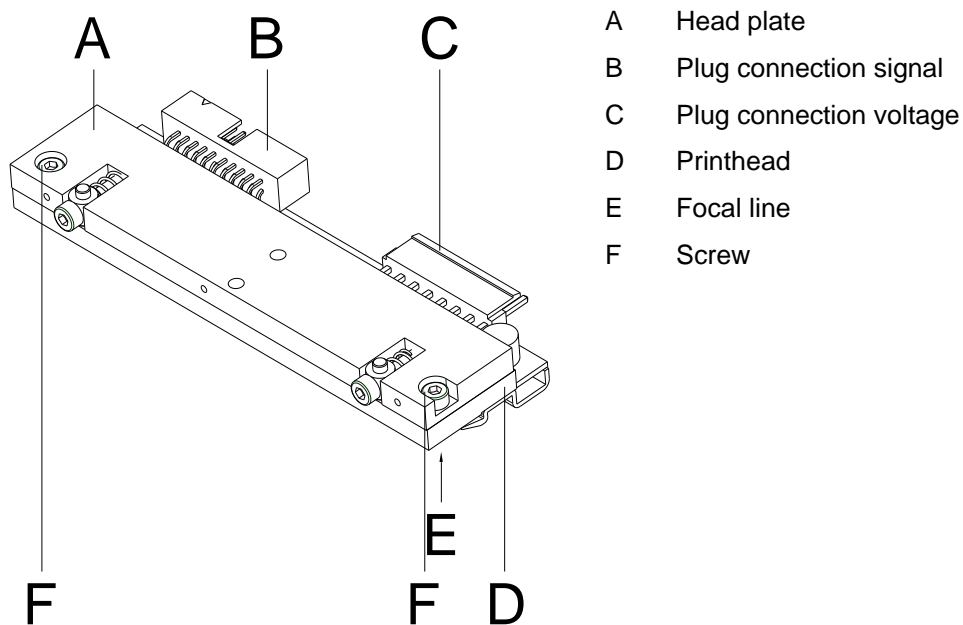

Figure 5



### NOTICE!

The printhead (D) is preinstalled on a head plate (A) and aligned at the factory.



### CAUTION!

Danger of abrasion when removing/installing the printhead!

- ⇒ Pay attention to the toothing when the tear-off edge is installed.

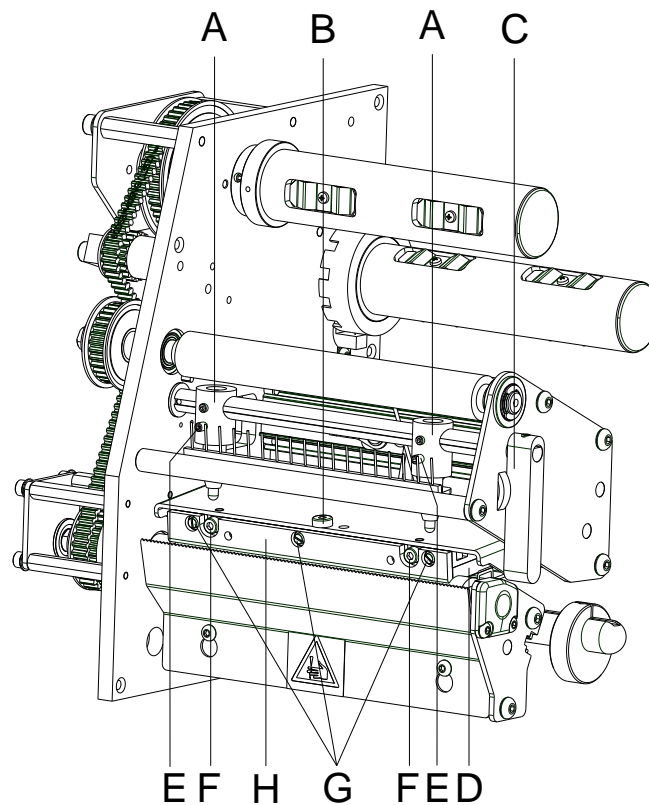

Figure 6

**Remove the printhead**

1. Remove labels and transfer ribbon from the label printer.
2. When the printhead is closed, loosen the fixing screw (B).
3. Turn the lever (C) counter clockwise to lift up the printhead.
4. If the printhead (D) is not disengaged on the pressure roller, continue loosen the fixing screw (B).
5. Remove the printhead carefully to the front until you can reach the plug connections.
6. Remove the plug connections and then remove the printhead (D).
7. Loosen the fixing screws (G) and remove the guiding (H).

**Install the printhead**

1. Mount the guiding (H) and fixing screws (G) at the printhead.
2. Attach the plug connections.
3. Position the printhead in the printhead mounting bracket in such a way that the pins are secured in the corresponding holes in the head plate.
4. Lightly keep the printhead mounting bracket on the pressure roller with one finger and check for correct positioning of the printhead.
5. Screw in the fixing screw (B) and tighten it.
6. Reload labels and transfer ribbon.
7. To move the printhead down, turn the pressure lever (C) in clockwise direction until it locks.
8. Check the resistance value on the type plate of printhead and if necessary change the value in the service functions/heater resistance.
9. Check the position of printout and if necessary adjust the print position (see chapter 5.3).

### 5.3 Adjust the Print Position

Press the key  to access the function menu.

Press the key  until the menu *Service Functions* is displayed.

Press the key  to select the menu.

Press the key  until the menu item *Zero point adjustment* is displayed.

#### Zero point adjustment in Y direction

Indication of value in 1/100 mm.

After replacing the printhead - the print cannot be continued at the same position on the label, the difference can be corrected in printing direction.



#### NOTICE!

The value for zero point adjustment is set ex works. After replacing the printhead, only service personnel are allowed to set this value anew.

#### Zero point adjustment in X direction

Press the key  to move to the next menu item.

Indication of value in 1/100 mm.

After replacing the printhead - the print cannot be continued at the same position on the label, the difference can be corrected across the printing direction.



#### NOTICE!

The value for zero point adjustment is set ex works. After replacing the printhead, only service personnel are allowed to set this value anew.

## 5.4 Replace the Pressure Roller

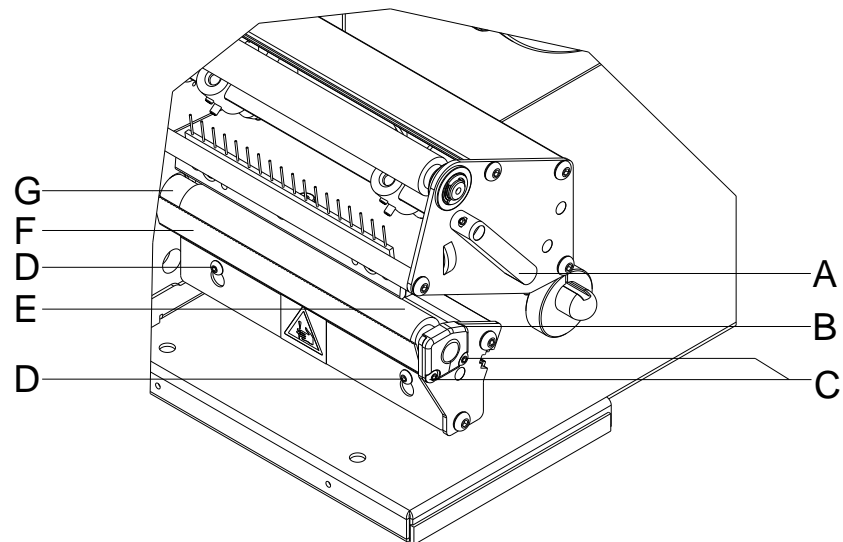

Figure 7

### Remove the pressure roller

1. Turn the lever (A) counter clockwise to lift up the printhead.
2. Remove labels and transfer ribbon from the label printer.
3. If mounted, remove the tear-off edge (F) by loosening the screws (D).
4. Loosen the two screws (C) on the bearing cover (B) and remove the bearing cover.
5. Pull the pressure roller (E) out of the carrier (G).

### Install the pressure roller

1. Insert the new pressure roller (E) into the carrier (G). The correct position of the carrier pin of the pressure roller (E) must be observed.
2. Mount the bearing cover (B) to the bearing plate below using the two screws (C).
3. When reassembling, make sure that the pressure roller (E) is seated without play.
4. Any axial play in the pressure roller must be eliminated by tensioning the carrier (G) and the mounted pressure roller (E).
5. Reload labels and transfer ribbon.
6. To move the printhead down, turn the pressure lever (A) in clockwise direction until it locks.

## 5.5 Replace the Label Photocell



### NOTICE!

Soiling of the label photocell can also cause malfunctions. Before replacing the label photocell, check whether it is soiled and clean it if necessary (see chapter 4.5, on page 17).

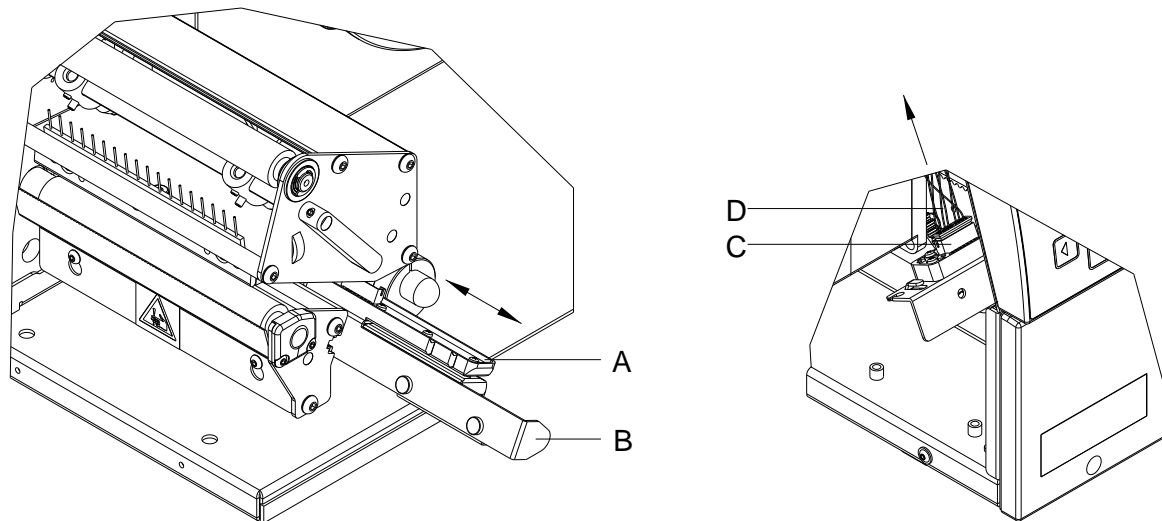

Figure 8

### Remove the label photocell

1. Remove labels and transfer ribbon from the label printer.
2. Remove the left printer cover.
3. Slide the label photocell assembly onto the tab (B) towards the left printer cover until it stops.
4. Unplug the cable (D) from the plug (C) on the rear end of the label photocell (A).
5. Pull out the label photocell (A) via the tab (B) towards the right cover side.

### Install the label photocell

1. Insert the label photocell (A) into the guide from the cover side and slide it onto the tab towards the left printer cover.
2. Connect the cable (D) with the plug (C) of the label photocell (A).
3. Pull the label photocell (A) via the tab (B) as far as possible towards the right cover side.  
This prevents the cable (D) from being pinched when installing the left printer cover.
4. Install the left printer cover.
5. Reload labels and transfer ribbon.
6. Adjust the label photocell.



## 5.6 Replace the CPU PCB

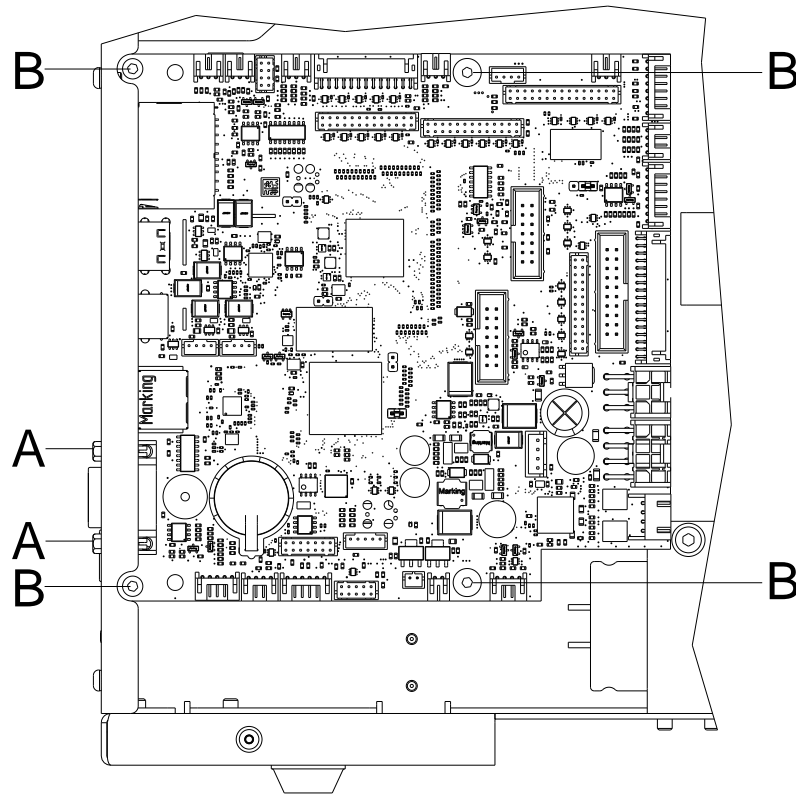

**Figure 9**

### Remove the CPU PCB

1. If possible, save the printer configuration to a SD card.
2. Unplug the printer from the electrical outlet.
3. Detach all interface cables from the back of the printer.
4. Remove the memory card from the slot.
5. Screw off the left printer cover.
6. Unplug all side plug connections from the CPU PCB.
7. Remove two screw bolts (A) and four fixing bolts (B) from the CPU PCB.
8. Carefully remove the CPU PCB.

### Install the CPU PCB

1. Place the CPU PCB into the printer.
2. Secure the PCB with two screw bolts (A) and four fixing screws (B).
3. Insert all plug connections on the PCB.
4. Pull the label photocell towards the right cover side as far as possible (see chapter 4.5, on page 20) and install the left printer cover.
5. Restore all interface connections on the back of the printer.
6. Connect the power cable at the rear of the printer.
7. Update the firmware if necessary.
8. Adjust the label photocell.
9. Load the printer configuration from the memory card if possible. Otherwise, set the printer configuration via the operating panel.

## 5.7 Replace the Power Supply

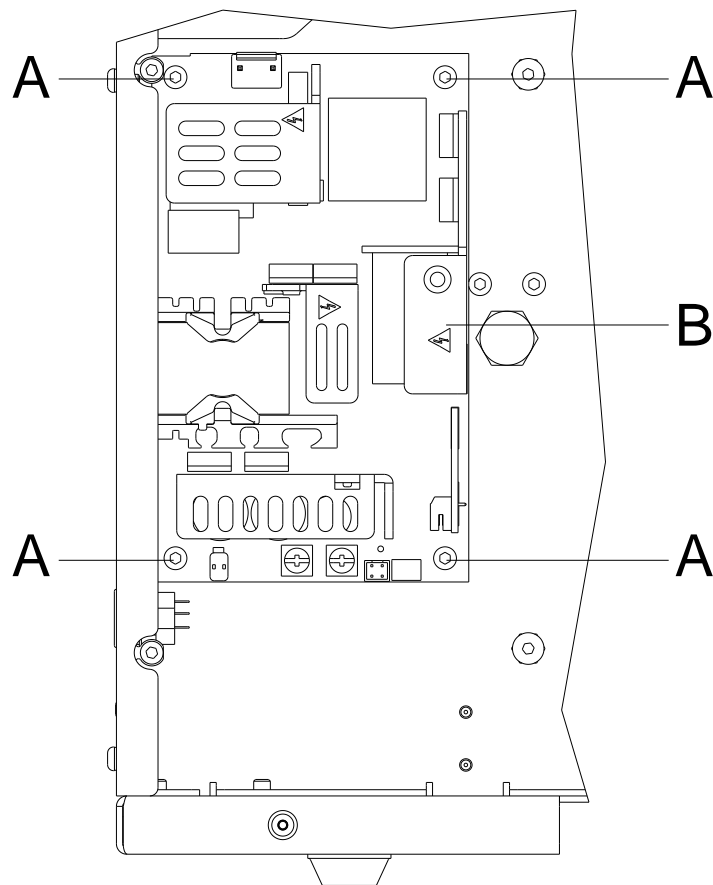

**Figure 10**

### Remove the power supply

1. Unplug the printer from the electrical outlet.
2. Screw off the left printer cover.
3. Remove the CPU PCB (see chapter 5.6, page 25).
4. Unplug all cable connections from power supply (B).
5. Hold the power supply firmly and unscrew the four screws (A) at the chassis of printer.
6. Remove the power supply unit.
7. Remove two screws (A) and two washers (B) of Step-Down PCB (C).

### Install the power supply

1. Insert the new power supply (B) and secure it with the screws (A) at the chassis.
2. Connect all cable connections at the power supply (B). Pay attention to polarity!
3. Install the CPU PCB (see chapter 5.6, page 25).
4. Install the left printer cover.
5. Connect the power cable at the rear of the printer.

## 5.8 Replace the Battery



### **DANGER!**

Danger of explosion due to improper replacement of the battery!

- ⇒ Use non-conductive tools.
- ⇒ Pay attention to polarity.

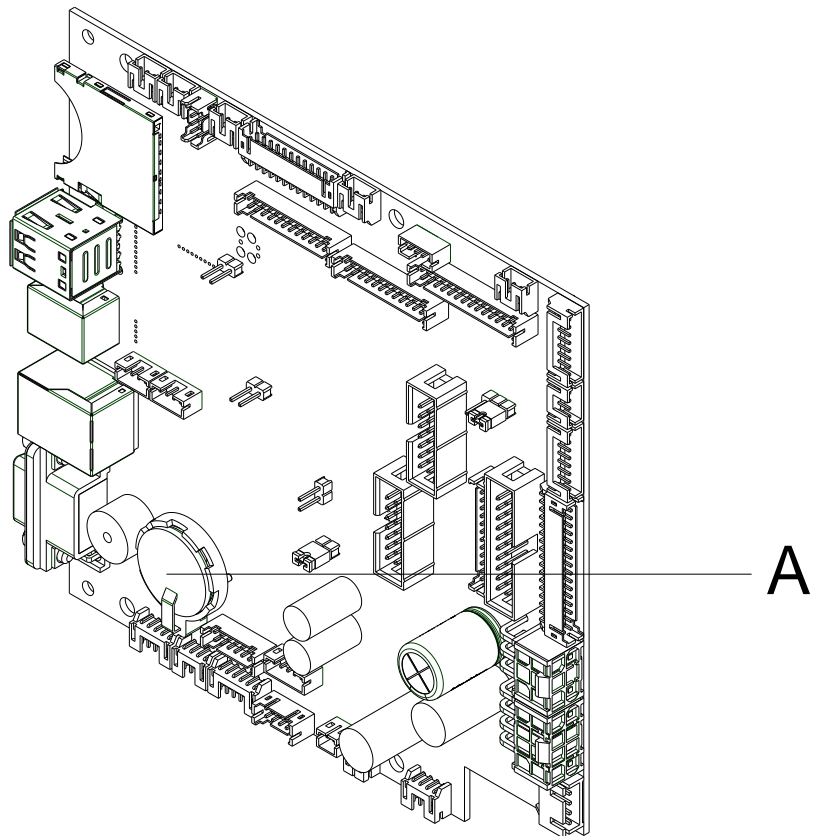

**Figure 11**

1. Lift up the fixing bracket by means of a non-metallic device (e.g. plastic ruler).
2. Remove the battery (A).
3. Insert a new battery (CR 2032) into the support and pay attention to position of polarity.



## 6 Adjustments, Settings and Alignments



### **DANGER!**

Risk of death via electric shock!

- ⇒ Before opening the housing cover, disconnect the label printer from the mains supply and wait for a moment until the power supply unit has discharged.

### 6.1 Adjust the Print Mechanism

Major adjustment of the printing mechanism beyond format-based settings is only required if the printhead assembly has been removed or parts in this area have been replaced. Excluded from this is the replacement of the printhead, after which readjustment is generally not required.

The following print quality imperfections may indicate maladjustment of the printing mechanism:

- Print image too light
- Print image is spotty
- Print image lighter on one side
- Horizontal lines not parallel to the horizontal label edges
- Clear lateral drift of the transfer ribbon



### **NOTICE!**

Print image errors can also arise from wrinkling of the transfer ribbon. This is why the transfer ribbon feed path and the head locking system should be checked before making adjustments to the printing mechanism (see '*operating manual*').

Adjustment of the printing mechanism encompasses the following procedures in the order specified:

1. Adjust the position of printhead (see chapter 6.2, on page 29).
2. Adjust the head contact pressure (see page 31).
3. Adjust the transfer ribbon feed path (see chapter 6.3, on page 32).

### 6.2 Adjust the Printhead

Complete the following printhead settings to achieve the best possible print image:

- ⇒ Align the heating line with the highest point of the pressure roller. Density of the print image is the greatest at this point.
- ⇒ Set the parallelism of horizontal lines with the edge of the label.

**CAUTION!**

The printhead assembly can be damaged.

Attempting to adjust the printhead when the fixing screw (B) is tight can lead to defects at the printhead assembly.

⇒ Always loosen the fixing screw (B) before adjusting the printhead.

**NOTICE!**

Open and close the printhead locking device after each step of the adjustment.

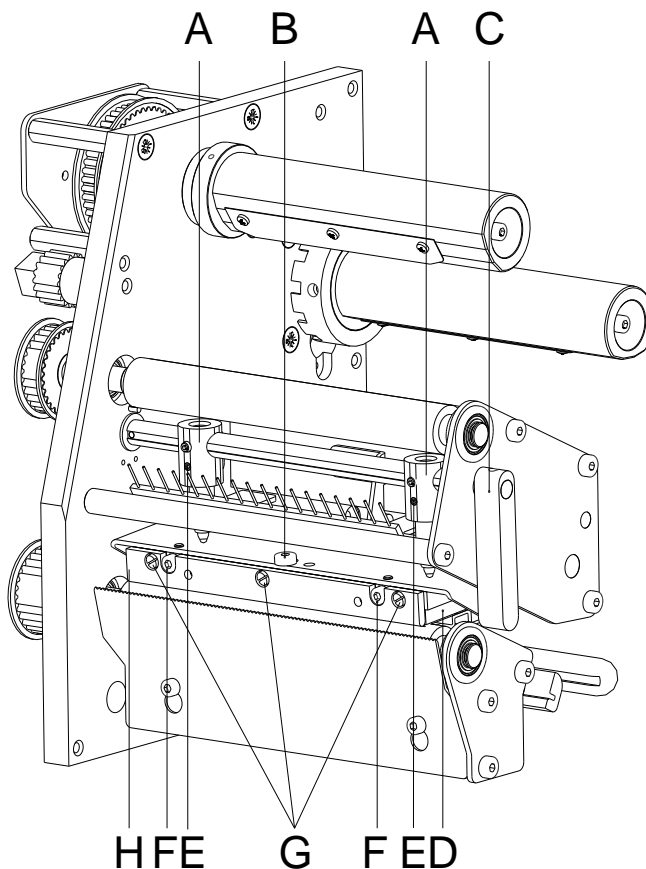
**Parallelism**

An important characteristic for a high quality print is the parallelism of the focal line of the thermal printhead to the pressure roll. Because of the fact that the position of focal line of the printhead depends on fluctuations caused by production, it is necessary to adjust the parallelism.

1. Loosen the fixing screw (B) with a hexagon key by approx. ¼ rotations.
2. Adjust the parallelism with the adjusting screws (F).  
Clockwise = printhead moves forwards  
Counter clockwise = printhead moves backwards
3. Adjust the parallelism as long as the printing result comes up to your full expectation.
4. Tighten again the fixing screw (B).
5. Start a print order with approx. 10 labels and control the correct passage of transfer ribbon.

**Figure 12**

## Pressure

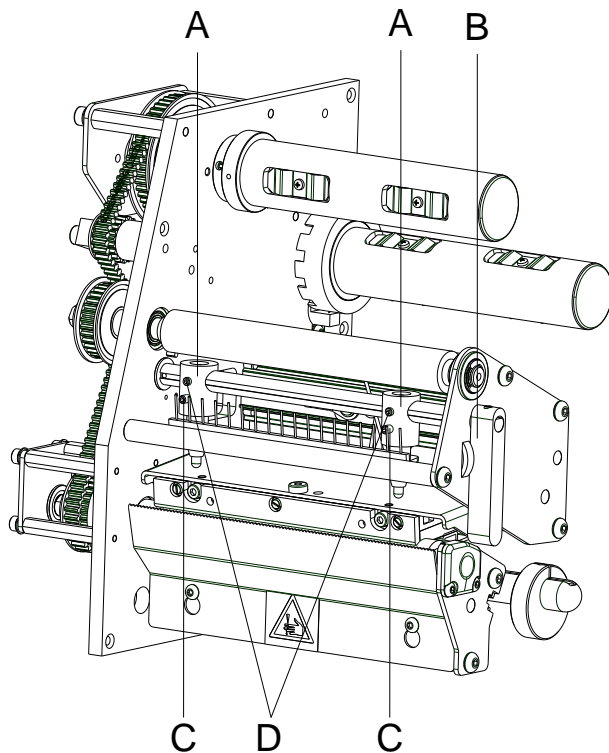

Increasing the head contact pressure leads to an improvement of the print image density on the corresponding side and to a shifting of the ribbon feed path in the corresponding direction.



### CAUTION!

Damage of printhead by unequal use!

⇒ Only change the factory settings in exceptional cases.

The selection of the smallest value can optimise the life cycle of printhead.

Figure 13

1. Turn the lever (B) clockwise to lock the printhead.
2. The printhead is pushed on via two plungers (A). The location of the right plunger must be set to the width of the label medium used so as to:
  - achieve even print quality across the entire label width,
  - prevent wrinkles in the feed path of the transfer ribbon,
  - prevent premature wearing of the pressure roller and printhead.
3. Loosen the screw (D) by approx. ¼ rotations.
4. Position the right plunger (A) above the outer label edge.
5. Tighten again the screw (D).
6. Turn the pressure screws (C) to change the pressure of printhead. Turning the pressure screws:
  - in clockwise direction increases the pressure
  - anticlockwise reduces the pressure.

## Print position

Check the position of printout and if necessary adjust the print position (see chapter 5.3).

### 6.3 Adjust the Transfer Ribbon Feed Path

Adjust the transfer ribbon feed path by changing the head contact pressure. Increasing the head contact pressure with the screws (A) and (B) shifts the ribbon feed path in the corresponding direction. Possibly arising formation of wrinkles can be eliminated by bowing the printhead.



#### CAUTION!

The printhead assembly can be damaged when bowing the printhead.

Turning the adjustment screw (D) too hard can cause damage to the printhead assembly.

- ⇒ As soon as a clear resistance is perceived when turning the adjustment screw (D), only continue turning the screw in very small increments, but no more than one eighth of a turn.
- ⇒ Only turn the adjustment screw (D) as far as is absolutely necessary.

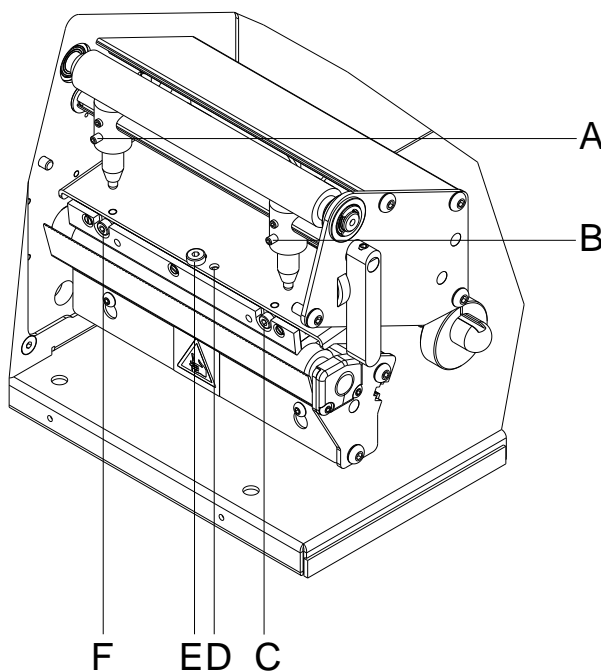
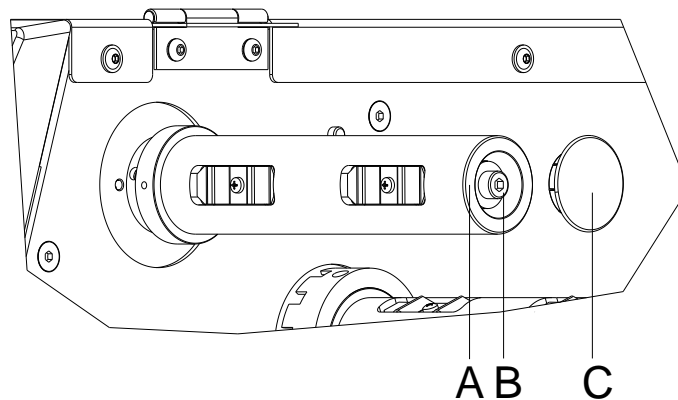

Figure 14

1. Check the transfer ribbon feed path. The wound up ribbon should be the same distance from the disk of the winder as the supply roller is from the disk of the rewinder.
2. If the ribbon runs inward or outward, turn the corresponding screw (C) or (F) clockwise in small increments.
3. Wait until the ribbon feed path has stabilized after each step of the adjustment.
4. Check the ribbon feed path for wrinkles.
5. If the wrinkles cannot be remedied (e.g. wrinkles in the centre), turn the adjustment screw (D) clockwise with extreme care (see warnings) using a hexagonal wrench (1.5 mm) and observe the ribbon feed path. When the adjustment screw (D) is tightened, the printhead is bent downward slightly in the centre. A slight lightening at the edge areas of the print image could occur here.



## 6.4 Adjust the Ribbon Rewinder/Unwinder



**Figure 15**

Due to the many different transfer ribbon variants regarding roller width, length and qualities it is necessary to provide the possibility to set transfer ribbon tension.

The transfer ribbon tension is to set in such way that no wrinkles in the ribbon appear but it is transported in the same way as the labels.

When using a too high ribbon tension this results usually in an excellent run of the transfer ribbon but this could lead to streaks onto the label or to a rip of ribbon particularly with narrow roles.

Ex factory the role tension is set to a transfer ribbon 110 mm width and standard quality. As approximate values for the factory setting the following can be accepted:

To be able to make settings, the cover (C) must be removed.

**Transfer ribbon unwinder:**

Distance of the screw head (B) to the roller face (A) = 2 mm

**Transfer ribbon rewinder:**

Distance of the screw head (B) to the roller face (A) = 4 mm

Tighten hex. the head screw (B) = Increasing the transfer ribbon tension

Loosen hex. the head screw (B) = Reducing the transfer ribbon tension

## 6.5 Adjust the Head Switch

The head switch prevents printing from occurring when the printhead is open.

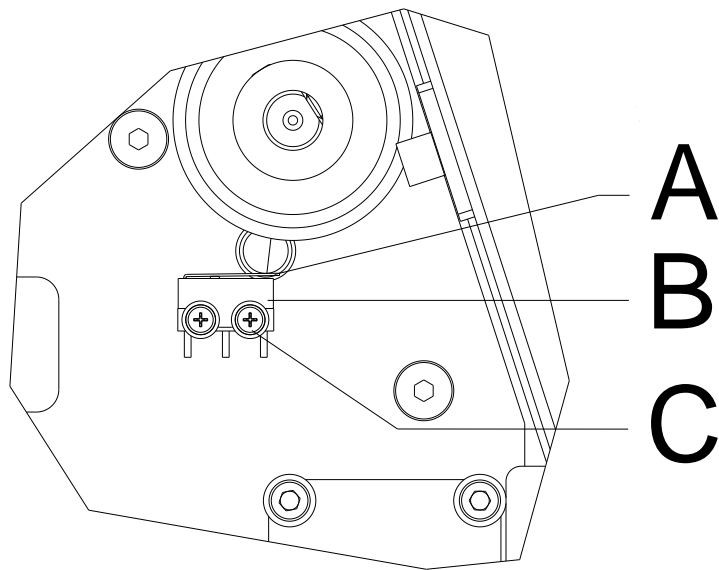

**Figure 16**

1. Unplug the printer from the electrical outlet.
2. Remove the left printer cover.
3. Lock the printhead.
4. Slightly loosen the fixing screws (C) of the head switch (B).
5. Move the head switch housing and switching lever (A) to a parallel position.
6. Screw down the head switch in this position.
7. Pull the label photocell towards the right cover side as far as possible (see chapter 5.5, on page 24) and install the left printer cover.

## 6.6 Oil and Lubricate



### NOTICE!

Make sure when oiling and greasing that no lubricants deposit on photocells, electronic components, circuit boards, printhead and rolls.

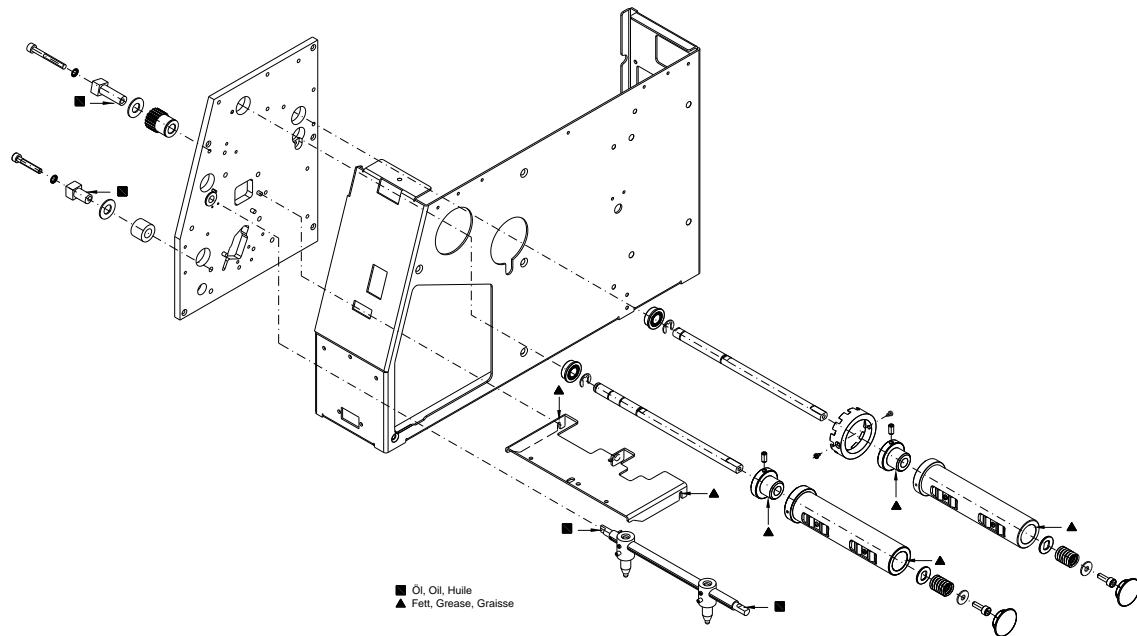

**Figure 17**

In case that dust or other dirt is deposit you have to clean the lubrication at first with alcohol.

Apply rather in regular intervals (once or twice a year) a bit of lubricant, as only rarely too much. Otherwise the surplus of lubricant could settle on neighbouring components and disturb the functions.

In case those components should have run it because of lack of lubricant, replace these as soon as possible so the functions of the components and the printer remain.

Install again all components which you have dismantled for the lubrication in the correct position.

Take care e.g. tensions of belt, springs etc.



## 7 Retrofit with Options



### **DANGER!**

Risk of death via electric shock!

⇒ Before opening the housing cover, disconnect the label printer from the mains supply and wait for a moment until the power supply unit has discharged.

### 7.1 I/O Plate

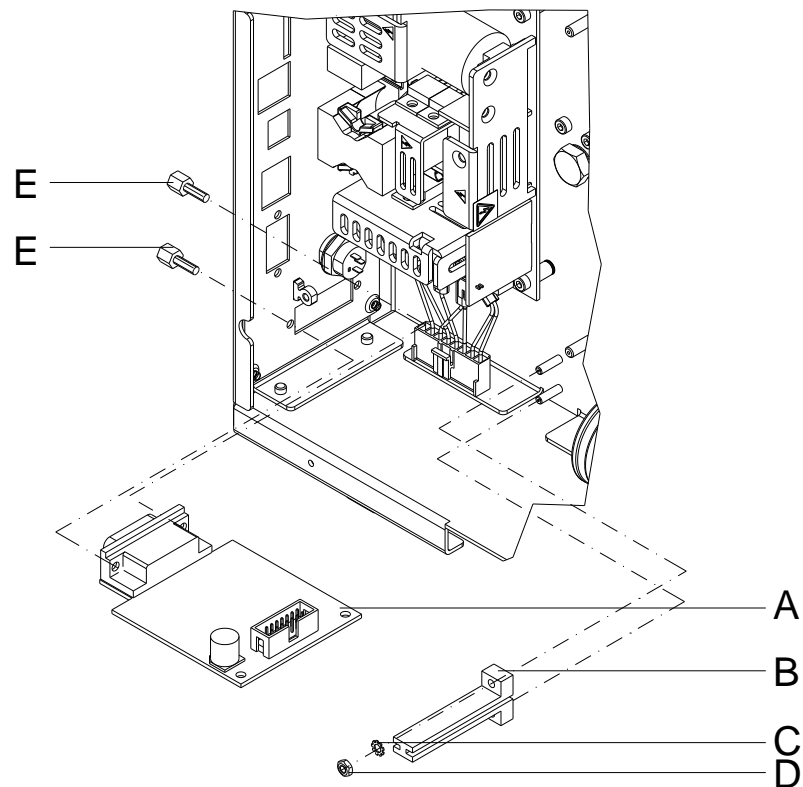

**Figure 18**

1. Remove the CPU PCB (see chapter 5.6, on page 25).
2. Remove the cover at the interface disruption from the chassis rear.
3. Fix the I/O plate (A) with the fixing screws (E) at the disruption.
4. Fix the platine holder (B) with the protective disc (C) and hex nut (D) at the chassis.
5. Insert the connecting cables for inputs/outputs corresponding to the wiring plan (see chapter 10, on page 59) into the appropriate plug-in positions of the I/O plate.
6. Install the CPU PCB (see chapter 5.6, on page 25).

## 7.2 Dispenser Unit

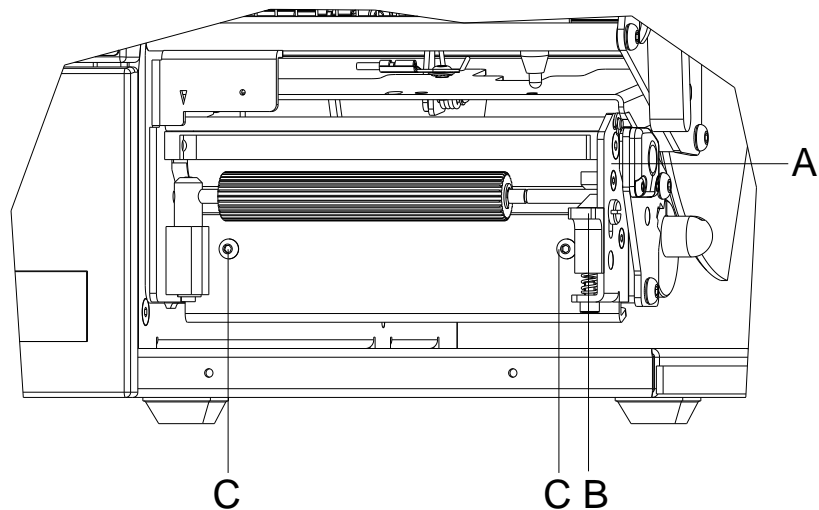

**Figure 19**

### **Dispenser unit without photocell**

1. Remove the tear off edge (if mounted) at the front of the printer.
2. Press the button (B) to open the dispenser roller.
3. Fix the dispenser unit with hex. head screws (C) at the aluminium profile underneath the pressure roller.
4. Engage again the dispenser roller.

### **Dispenser unit with photocell**

1. Remove the left printer cover.  
Loosen two screws at the lower left printer edge and three screws at the chassis upper edge.
2. Remove the protective conductor at the inside of printer cover.
3. Guide the plug of the photocell cable through the round opening in the chassis.
4. Hold the dispenser unit (A) in front of the pressure roller. Guide the photocell cable down between the chassis and the left bearing plate of the dispenser and lead the plug of the photocell cable through the round opening in the chassis.
5. Insert the photocell cable corresponding to the wiring plan (see chapter 10, on page 59) into the appropriate plug-in positions of the dispenser photocell.
6. Connect the protective conductor to the inside of printer cover.
7. Mount again the printer cover.

### 7.3 Cutter Unit



#### WARNING!

Risk of injury, particularly during maintenance, the cutter blades are sharp!

- ⇒ Switch off the printer before attaching the cutter!
- ⇒ The cutter may only be used when it is mounted on the printer!
- ⇒ Do not try to cut any materials which exceed the maximum width or thickness specifications.
- ⇒ Do NOT touch the area of the moving blades!

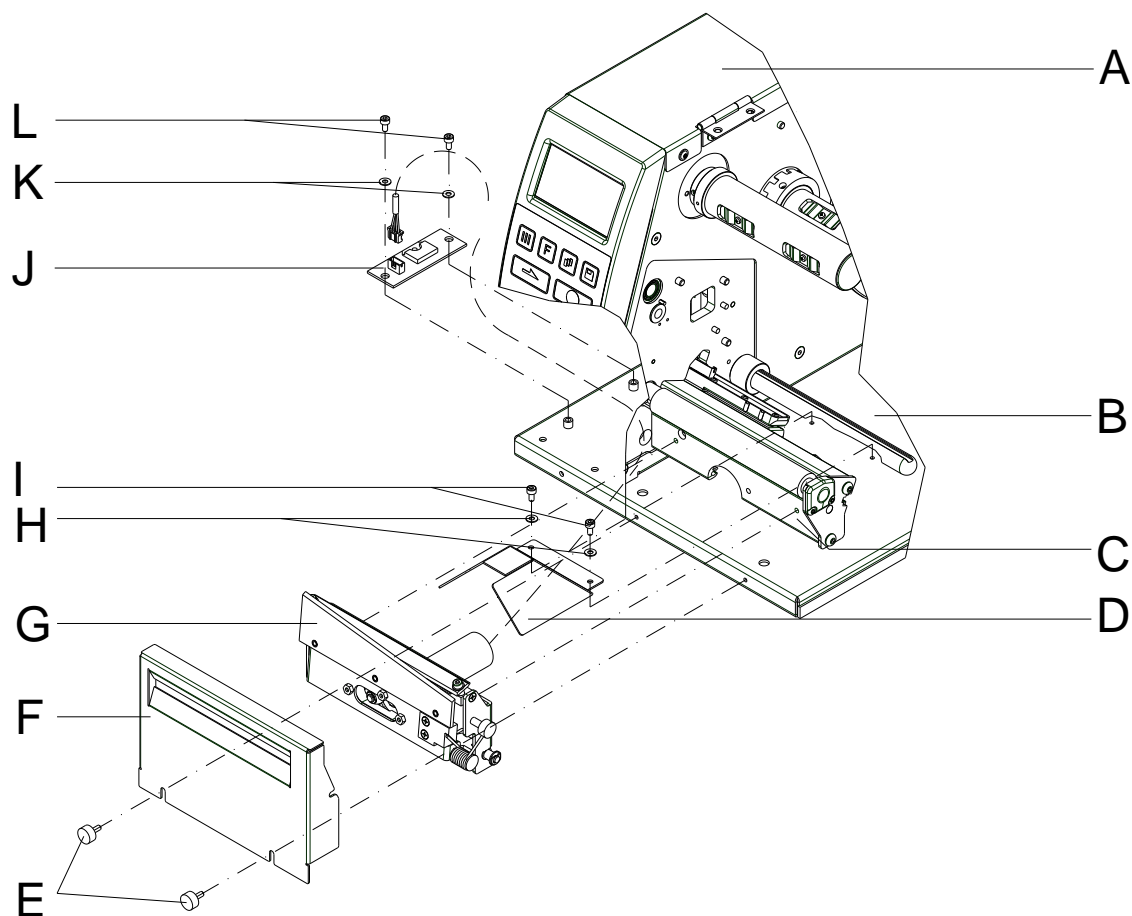

Figure 20

1. Remove the tear off edge (if mounted) and the fixing screws at the front of printer.
2. Remove the left printer cover.  
Loosen two screws at the lower left printer edge and three screws at the chassis upper edge.
3. Remove the protective conductor at the inside of the printer cover (A).

4. Mount the enclosed motor cover (D) with the discs (H) and screws (I) at the printer base (B).
5. Guide the plug of the cutter cable through the round opening in the chassis.
6. Fix the cutting unit (G) with the enclosed screws at the aluminium profile.
7. Mount the motor plate (J) with the washers (K) and screws (L) at the printer base (B).
8. Insert the cutter and connection cable corresponding to the wiring plan (see chapter 10, on page 59) into the appropriate plug-in positions of the PCB.
9. Connect the protective conductor to the inside of printer cover.
10. Mount again the printer cover.
11. Mount the cover (F) on the printer base (B) with screws (E).



## 8 Error Correction

Error message	Cause	Remedy
1 Line too high	Line rises up completely or partly over the upper edge of label.	Move line down (increase Y value). Check rotation and font.
2 Line too low	Line rises up completely or partly over the bottom edge of label.	Move line up (reduce Y value). Check rotation and font.
3 Character set	One res. several characters of the text is res. are not available in the selected font.	Change text. Change font.
4 Unknown BC type	Selected code is not available.	Check code type.
5 Illegal rotation	Selected rotation is not available.	Check rotation.
6 CV font	Selected font is not available.	Check font.
7 Vector font	Selected font is not available.	Check font.
8 Measuring label	While measuring no label was found. Set label length is too large.	Check label length and if labels are inserted correctly. Restart measuring anew.
9 No label found	No label available. Soiled label photocell. Labels not inserted correctly.	Insert new label roll. Check if labels are inserted correctly. Clean the label photocell.
10 No ribbon	During the print order the ribbon roll becomes empty. Defect at the transfer ribbon photocell.	Change transfer ribbon. Check transfer ribbon photocell (service functions).
11 COM FRAMING	Stop bit error.	Check stop bits. Check baud rate. Check cable (printer and PC).
12 COM PARITY	Parity error.	Check parity. Check baud rate. Check cable (printer and PC).
13 COM OVERRUN	Loss of data at serial interface (RS-232).	Check baud rate. Check cable (printer and PC).
14 Field number	Received line number is invalid.	Check sent data. Check connection PC - printer.
15 Length mask	Invalid length of received mask statement.	Check sent data. Check connection PC - printer.

Error message	Cause	Remedy
16 Unknown mask	Transferred mask statement is invalid.	Check sent data. Check connection PC - printer.
17 Missing ETB	No end of data found.	Check sent data. Check connection PC - printer.
18 Invalid character	One res. several characters of the bar code is res. are not valid.	Change bar code data. Change font.
19 Invalid statement	Unknown transferred data record.	Check sent data. Check connection PC - printer.
20 Invalid check digit	For check digit control the entered res. received check digit is wrong.	Calculate check digit anew. Check code data.
21 Invalid SC code	Selected SC factor is invalid for EAN res. UPC.	Check SC factor.
22 Invalid number of digits	Entered digits for EAN res. UPC are invalid < 12; > 13.	Check number of digits.
23 Type check digit	Selected check digit calculation is not available in the bar code.	Check calculation of check digit. Check bar code type.
24 Invalid extension	Selected zoom factor is not available.	Check zoom factor.
25 Offset sign	Entered sign is not available.	Check offset value.
26 Offset value	Entered offset value is invalid.	Check offset value.
27 Printhead temperature	Printhead temperature is too high. Defective printhead sensing device.	Reduce contrast. Change printhead.
28 Cutter error	With cut an error occurred. Paper jam.	Check label run. Check cutter run.
29 Invalid parameter	Entered data do not correspond to the characters allowed from the application identifier.	Check code data.
30 Application Identifier	Selected application identifier is not available in GS1-128.	Check code data.
31 HIBC definition	Missing HIBC system sign. Missing primary code.	Check definition of HIBC code.
32 System clock	Real Time Clock function is selected but the battery is empty. Defective RTC.	Change battery. Change RTC component.

Error message	Cause	Remedy
33 No CF interface	Interrupted connection CPU - CF card. Defective CF card interface.	Check connection CPU - CF card interface. Check CF card interface.
34 No print memory	Not enough print memory available.	Check CF assembly on CPU.
35 Printhead open	At start of a print order the printhead is open.	Close the printhead and start print order anew.
36 BCD invalid format	BCD error Invalid format for the calculation of Euro variable.	Check entered format.
37 BCD overflow	BCD error Invalid format for the calculation of Euro variable.	Check entered format.
38 BCD division	BCD error Invalid format for the calculation of Euro variable.	Check entered format.
39 FLASH ERROR	Flash component error.	Run a software update. Change CPU.
40 Length command	Invalid length of the received command statement.	Check data sent. Check connection PC - printer.
41 No drive	CF card not found / not correctly inserted.	Insert CF card correctly.
42 Drive error	Impossible to read CF card (faulty).	Check CF card, if necessary change it.
43 Unformatted	CF Card not formatted.	Format CF card.
44 Delete directory	Attempt to delete the actual directory.	Change directory.
45 Invalid path	Too long indication of path.	Indicate a shorter path.
46 Drive write-protected	Memory card is write-protected.	Deactivate write protection.
47 Directory not file	Attempt to indicate a directory as file name.	Correct your entry.
48 File already open	Attempt to change a file during an access is active.	Select another file.
49 No file/directory	File does not exist on CF card.	Check file name.
50 Invalid file name	File name contains invalid characters.	Correct entry of name, remove special characters.
51 Internal file error	Internal file system error.	Please contact your distributor.

Error message	Cause	Remedy
52    Root full	The max. number (64) of main directory entries is reached.	Delete at least one main directory entry and create subdirectories.
53    Drive full	Maximum CF capacity is reached.	Use new CF Card, delete no longer required files.
54    File/directory exists	The selected file/directory already exists.	Check name, select a different name.
55    File too large	During copying procedure not enough memory space onto target drive available.	Use a larger target card.
56    No update file	Errors in update file of firmware.	Start update file anew.
57    Invalid graphic file	The selected file does not contain graphic data.	Check file name.
58    Directory not empty	Attempt to delete a not empty directory.	Delete all files and sub-directories in the desired directory.
59    No CF interface	No CF card drive found.	Check connection of CF card drive. Contact your distributor
60    No media	No CF card is inserted.	Insert CF card in the slot.
61    Webserver error	Error at start of web server.	Please contact your distributor.
62    Wrong PH FPGA	The direct print module is equipped with the wrong FPGA.	Please contact your distributor.
63    End position	The label length is too long. The number of labels per cycle is too much.	Check label length res. the number of labels per cycle.
64    Zero point	Defective photocell.	Change photocell.
65    Compressed air	Pressure air is not connected.	Check pressure air.
66    External release	External print release signal is missing.	Check input signal.
67    Column too wide	Wrong definition of column width res. number of columns.	Reduce the column width res. correct the number of columns.
68    Scanner	The connected bar code scanner signals a device error.	Check the connection scanner/printer. Check scanner (dirty).
69    Scanner NoRead	Bad print quality. Printhead completely soiled or defective. Print speed too high.	Increase contrast. Clean printhead or exchange (if necessary). Reduce print speed.

Error message	Cause	Remedy
70 Scanner data	Scanned data does not correspond to the data which is to print.	Exchange printhead.
71 Invalid page	As page number either 0 or a number > 9 is selected.	Select a number between 1 and 9.
72 Page selection	A page which is not available is selected.	Check the defined pages.
73 Undefined page	The page is not defined.	Check the print definition.
74 Format user guiding	Wrong format for customized entry.	Check the format string.
75 Format date/time	Wrong format for date/time.	Check the format string.
76 Hotstart CF	No CF card found.	If option hotstart was activated, a CF card must be inserted. Switch off the printer before inserting the memory card.
77 Flip/Rotate	Selection of print of several columns and also mirror/rotate.	It is only possible to select one of both functions.
78 System file	Loading of temporary hotstart files.	Not possible.
79 Shift variable	Faulty definition of shift times (overlapping times).	Check definition of shift times.
80 GS1 Databar	General GS1 Databar error.	Check definition and parameter of GS1 Databar code.
81 IGP error	Protocol error IGP.	Check sent data.
82 Time generation	Printing creation was still active at print start.	Reduce print speed. Use printers' output signal for synchronization. Use bitmap fonts to reduce generating time.
83 Transport protection	Both DPM position sensors (start/end) are active.	Displace zero point sensor Check sensors in service functions menu
84 No font data	Font and web data is missing.	Run a software update.
85 No layout ID	Layout ID definition is missing.	Define layout ID onto the label.
86 Layout ID	Scanned data does not correspond to defined ID.	Wrong label loaded from CF card.
87 RFID no label	RFID unit cannot recognize a label.	Displace RFID unit or use an offset.
88 RFID verify	Error while checking programmed data.	Faulty RFID label. Check RFID definitions

Error message	Cause	Remedy
89 RFID timeout	Error at programming the RFID label.	Label positioning. Faulty label.
90 RFID data	Faulty or incomplete definition of RFID data.	Check RFID data definitions.
91 RFID tag type	Definition of label data does not correspond with the used label.	Check storage partitioning of used label type
92 RFID lock	Error at programming the RFID label (locked fields).	Check RFID data definitions. Label was already programmed.
93 RFID programming	Error at programming the RFID label.	Check RFID definitions.
94 Scanner timeout	The scanner could not read the bar code within the set timeout time.	
	Defective printhead. Wrinkles in transfer ribbon. Scanner wrong positioned. Timeout time too short.	Check printhead. Check transfer ribbon. Position scanner correctly, corresponding to the set feeding. Select longer timeout time.
95 Scanner layout difference	Scanner data does not correspond to bar code data.	Check adjustment of scanner. Check scanner settings / connection.
96 COM break	Serial interface error.	Check settings for serial data transmission as well as cable (printer-PC).
97 COM general	Serial interface error.	Check settings for serial data transmission as well as cable (printer-PC).
98 No software printhead FPGA	No printhead-FPGA data available.	Please contact your responsible distributor.
99 Load software printhead FPGA	Error when programming printhead-FPGA.	Please contact your responsible distributor.
100 Upper position	Option applicator: Sensor signal up is missing.	Check input signals / compressed-air supply.
101 Lower position	Option applicator: Sensor signal down is missing.	Check input signals / compressed-air supply.
102 Vacuum plate empty	Option applicator: Sensor does not recognize a label at vacuum plate.	Check input signals / compressed-air supply.

Error message	Cause	Remedy
103 Start signal	Print order is active but device not ready to process it.	Check start signal.
104 No print data	Print data outside the defined label. Selection of wrong module type (design software).	Check selected module type. Check selection of left/right version.
105 Printhead	No original printhead is used.	Check the used printhead. Contact your distributor.
106 Invalid Tag type	Wrong Tag type. Tag data do not match the Tag type in the printer.	Adapt data or use the correct Tag type.
107 RFID inactive	RFID module is not activated. No RFID data can be processed.	Activate RFID module or remove RFID data from label data.
108 GS1-128 invalid	Transferred GS1-128 bar code is invalid.	Verify bar code data (see GS1-128 bar code specification).
109 EPC parameter	Error at EPC calculation.	Verify data (see EPC specification).
110 Housing open	When starting the print order the housing cover is not closed.	Close the housing cover and start the print order anew.
111 EAN.UCC code	Transferred EAN.UCC code is invalid.	Verify bar code data (see corresponding specification).
112 Print carriage	Printing carriage does not move.	Check gear belt (possibly broken).
113 Applicator error	Option applicator: Error while using applicator.	Check applicator.
114 Left position	Option applicator: Left final position switch is not in correct position.	Check LEFT final position switch for correct function and position. Check function of pneumatics for cross traverse.
115 Right position	Option applicator: Right final position switch is not in correct position.	Check RIGHT final position switch for correct function and position. Check function of pneumatics for cross traverse.
116 Print position	Option applicator: The applicator is not in the print position when trying to print a label.	Check TOP and RIGHT final position switch for correct function and position. Check pneumatics for function
117 XML parameter	The parameters in the XML file are not correct.	Please contact your responsible distributor.

Error message	Cause	Remedy
118 Invalid variable	Transferred variable is invalid with customized entry.	Select correct variable without customized entry and transfer it.
119 No ribbon	During the print order the ribbon roll becomes empty. Defect at the transfer ribbon photocell.	Change transfer ribbon. Check transfer ribbon photocell (service functions).
120 Wrong directory	Invalid target directory when copying.	Target directory must not be within the source directory. Check target directory.
121 No label PH2	No label found at the rear printhead (DuoPrint). Soiled label photocell. Labels not inserted correctly.	Insert new label roll. Clean the label photocell. Check if labels are inserted correctly.
122 IP occupied	The IP address was already assigned.	Assign a new IP address.
123 Print asynchronous	The label photocell do not work in the order as it is expected according to print data.  The settings of the photocell are not correct.  Settings of label size and gap size are not correct.  No label found at the rear printhead.  Soiled label photocell.  Labels not inserted correctly.	Check label size and gap size.  Check label photocell settings.  Check correct loading of label material.  Insert new label roll.  Clean the label photocell.  Check if labels are inserted correctly.
124 Speed too low	The print speed is too slow.	Increase the speed of customers' machine.
125 DMA buffer	Communication problem HMI.	Restart the printer.
126 UID conflict	Configuration RFID programming faulty.	Run RFID initialising.
127 Module not found	RFID module not available.	Check the RFID module connection.  Please contact your responsible distributor.
128 No release signal	No print release by higher-level control (customer machine).	Activate release signal at the higher-level control.



Error message	Cause	Remedy
129 Wrong firmware	Firmware does not match the used printer type.	Use firmware that fits to the printer type. Please contact your responsible distributor.
130 Language missing	Language file for the set printer language is not available.	Please contact your responsible distributor.
131 Wrong material	Label material does not fit to printing data.	User label material with suitable label and/or gap length.
132 Invalid mark-up tag	Invalid mark-up formatting characters in text.	Correct the formatting characters in the text.
133 Script not found	LUA script file not found.	Check the file name.
134 Script failure	LUA script is incorrect.	Check the script.
135 Script user error	Error in LUA script user input.	Correct the input value.
136 No reprint available	No label data for reprinting available.	Send new label data to the printer.
137 Printhead short circuit	Electrical short at the printhead.	Check the used printhead. Please contact your distributor.
138 Too less ribbon	Transfer ribbon ends.	Change transfer ribbon.
139 Rewinder error	Label band is torn	Load a new label roll. Stick together the label band.
140 Rewinder motor blocked	External rewinder motor is blocked.	Switch off the printing system and check mechanical resistance. Change the full label roll.
141 Hardware error	A hardware component could not be found.	Please contact your responsible distributor.
142 No print mechanics	No print mechanics connected.	Check connection (print mechanics – control unit)



## 9 Control Inputs and Outputs

By means of a maximum of 16 control inputs and outputs which, in the following, are also referred to as ports, different functions of the printer system can be triggered and operating states can be displayed.

The ports are provided by means of a D-Sub bushing (26pin HD) at the rear panel of the printer system and are galvanically isolated from protective earth (PE) by means of an optocoupler semi-conductor route.

Each port can be configured as input and as output. This function however, is predefined in the printer software and cannot be changed by the user.

The following parameters can be changed and set by using the menu: debounce times and high or low active.

### Printer, internal circuitry

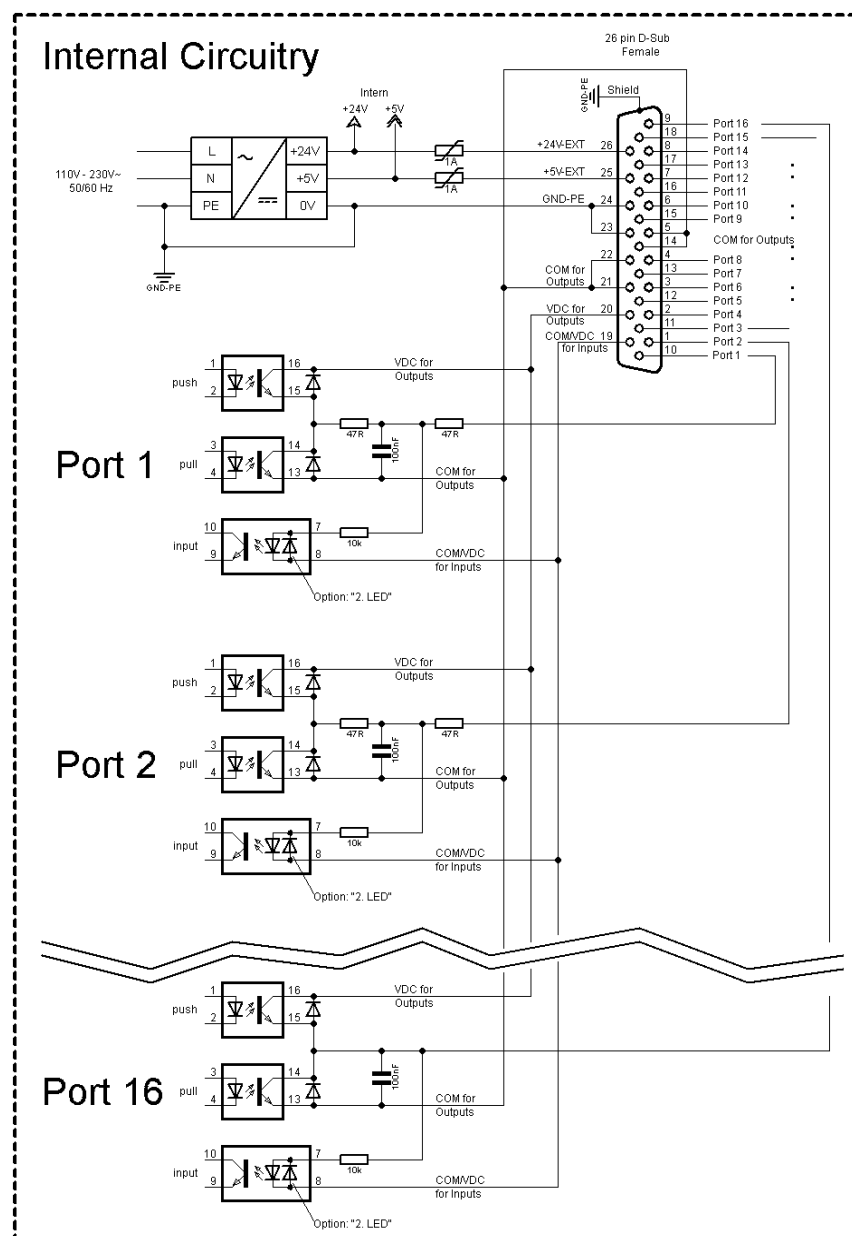
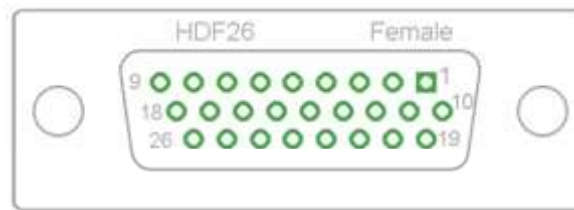

Figure 21

**Configuration of  
D-Sub socket****Figure 22****Cable identification**

Number	Color
1	white
2	brown
3	green
4	yellow
5	grey
6	pink
7	blue
8	red
9	black
10	violet
11	grey-pink
12	red-blue
13	white-green
14	brown-green
15	white-yellow
16	yellow-brown
17	white-grey
18	grey-brown
19	white-pink
20	pink-brown
21	white-blue
22	brown-blue
23	white-red
24	brown-red
25	white-black
26	brown-black

Port 1 to Port 16 = Assignment for I/O Profile *Std\_Label*

Identification	Pin	Description / Function
Port 1	10	Print start and cut (Input)
Port 2	1	Reprint last printed label (Input)
Port 3	11	Counter Reset (Input)
Port 4	2	Option applicator only: Start application (Input)
Port 5	12	Error reset (Input)
Port 6	3	Cancel all print jobs (Input)
Port 7	13	No function
Port 8	4	No function
Port 9	15	Error (Output)
Port 10	6	Print order activ (Output)
Port 11	16	Dispenser photocell: Label exists at dispenser photocell (Output)
Port 12	7	Single print (Output)
Port 13	17	Ready (Output)
Port 14	8	Option applicator only: Ready for application (Output)
Port 15	18	Option scanner only: Bar code not readable (Output)
Port 16	9	Prior warning for transfer ribbon end (Output)
COM/VDC for Inputs	19	Common reference potential of all control inputs. 'COM/VDC for Inputs' is usually connected with the (-) terminal of the control voltage and the control inputs are switched to active (+). By means of the option '2nd LED', 'COM/VDC for Inputs' can optionally be connected with the (+) terminal of the control voltage. Then, the control inputs are switched to active (-).
VDC for Outputs	20	Common supply connection of all control outputs. 'VDC for Outputs' must be connected with the (+) terminal of the control voltage. Never leave 'VDC for Outputs' open even if no output is used.
COM for Outputs	5,14 21,22	Common reference potential of all control outputs. 'COM for Outputs' must be connected with the (-) terminal of the control voltage. Never leave 'COM for Outputs' open even if no output is used.
GND-PE	23,24	'GND-PE' is the reference potential of the '+5 VDC EXT' and '+24 VDC EXT' voltages provided by the printer system. 'GND-PE' is printer internally connected with protective earth (PE).
+ 5 VDC EXT	25	5 Volt DC output for external use. Max. 1 A. This voltage is provided from direct print module and can be used e.g. as control voltage. Never apply any external voltage to this output.
+ 24 VDC EXT	26	24 Volt DC output for external use. Max. 1 A. This voltage is provided from direct print module and can be used e.g. as control voltage. Never apply any external voltage to this output.

Port 1 to Port 16 = Assignment for I/O Profile *StdFileSelLabel*

Identification	Pin	Description / Function
Port 1	10	Print start and cut (Input)
Port 2	1	Error reset (Input)
Port 3	11	Number of the file to load Bit 0 (Input)
Port 4	2	Number of the file to load Bit 1 (Input)
Port 5	12	Number of the file to load 2 (Input)
Port 6	3	Number of the file to load 3 (Input)
Port 7	13	Number of the file to load 4 (Input)
Port 8	4	Number of the file to load 5 (Input)
Port 9	15	Error (Output)
Port 10	6	Print order active (Output)
Port 11	16	Dispenser photocell: Label exists at dispenser photocell (Output)
Port 12	7	Printing (Output)
Port 13	17	Ready (Output)
Port 14	8	No function
Port 15	18	Option scanner only: Bar code not readable (Output)
Port 16	9	Transfer ribbon prior warning (Output)

Port 1 to Port 16 = Assignment for I/O Profile *APL*

Identification	Pin	Description / Function
Port 1	10	Print start and cut (Input)
Port 2	1	Reprint last printed label (Input)
Port 3	11	Counter reset (Input)
Port 4	2	Option applicator only: Start application (Input)
Port 5	12	Error reset (Input)
Port 6	3	Cancel all print jobs (Input)
Port 7	13	No function
Port 8	4	No function
Port 9	15	Error (Output)
Port 10	6	Print order active (Output)
Port 11	16	Dispenser photocell: Label exists at dispenser photocell (Output)
Port 12	7	Printing (Output)
Port 13	17	Ready (Output)
Port 14	8	Option applicator only: Ready for application (Output)
Port 15	18	Option applicator only: Pad is in printing position (Output)
Port 16	9	Transfer ribbon prior warning (Output)

## Technical data

Plug Connector	
Type	D-Sub connector High Density 26-pin. / connector
Manufacturer	W+P-Products
Reference number	110-26-2-1-20
Output Voltages (connected with GND-PE)	
+ 24 V / 1 A	Fuse: Polyswitch / 30 V / 1 A
+ 5 V / 1 A	Fuse: Polyswitch / 30 V / 1 A
Port 1 - 15	
<b>Input</b>	
Voltage	5 VDC ... 24 VDC
Impedance	$47\Omega + (100\text{nF} \parallel 10\text{ k}\Omega)$
<b>Output</b>	
Voltage	5 VDC ... 24 VDC
Impedance	$47\Omega + (100\text{nF} \parallel 10\text{ k}\Omega \parallel 47\Omega)$
Current max.	High +15 mA Low -15 mA
Port 16	
<b>Input</b>	
Voltage	5 VDC ... 24 VDC
Impedance	$100\text{nF} \parallel 10\text{ k}\Omega$
<b>Output</b>	
Voltage	5 VDC ... 24 VDC
Impedance	$100\text{nF} \parallel 10\text{ k}\Omega$
Current max.	High +500 mA (Darlington BCP56-16) Low -500 mA (Darlington BCP56-16)
Optocoupler	
Output	TCMT4106, CTR 100 % - 300 %, Vishay or TLP281-4(GB), CTR 100 % - 600 %, Toshiba
Input	TCMT4106, CTR 100 % - 300 %, Vishay or TLP281-4(GB), CTR 100 % - 600 %, Toshiba
Input Option 2nd LED	TCMT4600, CTR 80 % - 300 %, Vishay or TLP280-4, CTR 33 % - 300 %, Toshiba

**Example 1**

Device connection to a machine with S7-300 SPS.

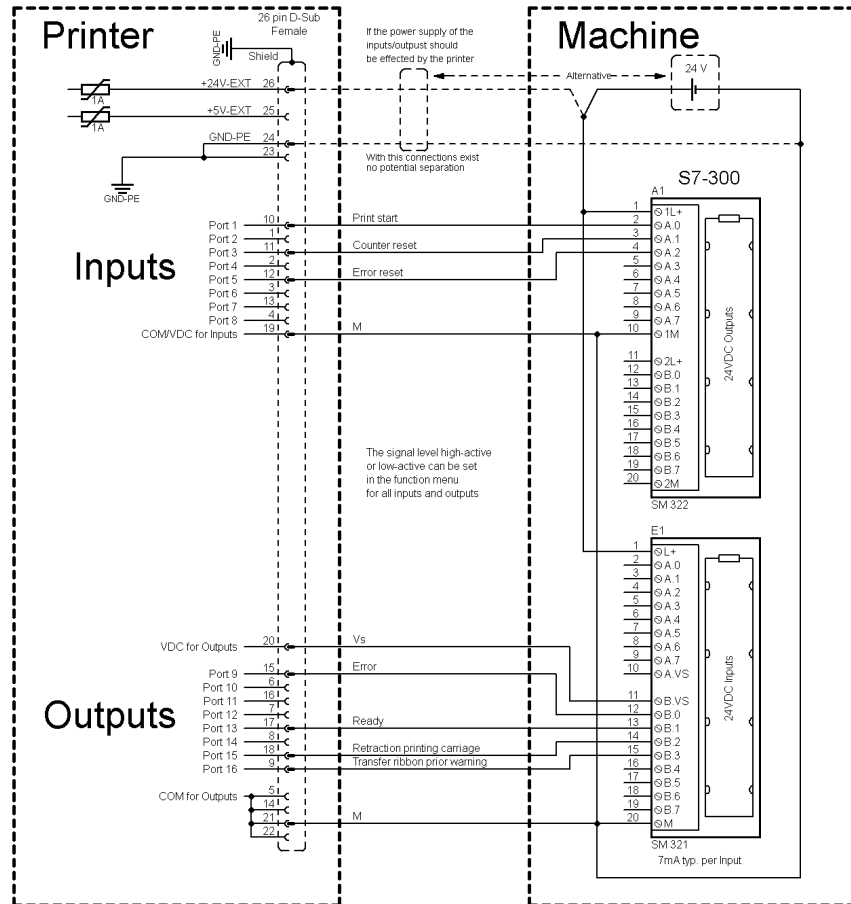
**Figure 23****Example 2**

Device connection to an operating panel.

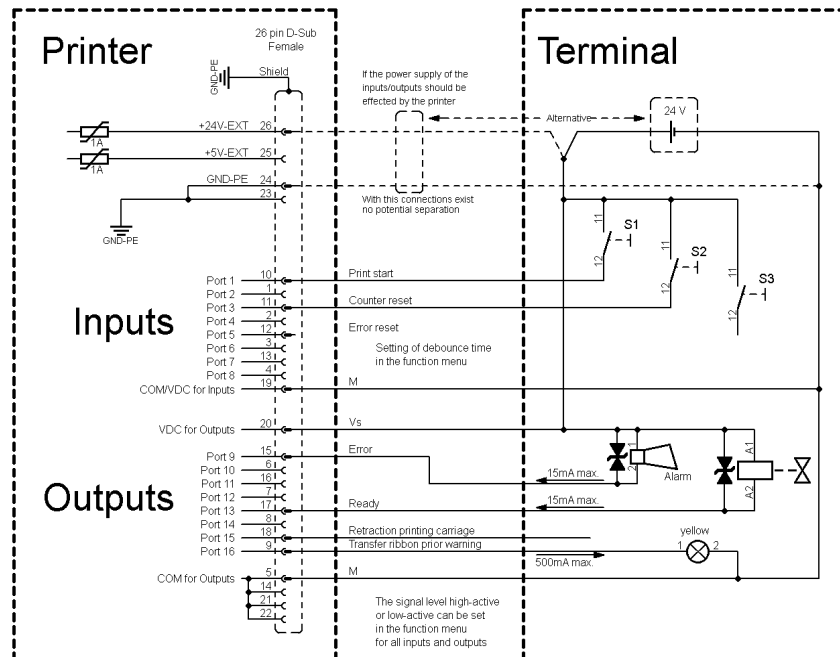
**Figure 24**



**Example 3**

Device connection version if 'Option: 2. LED'.

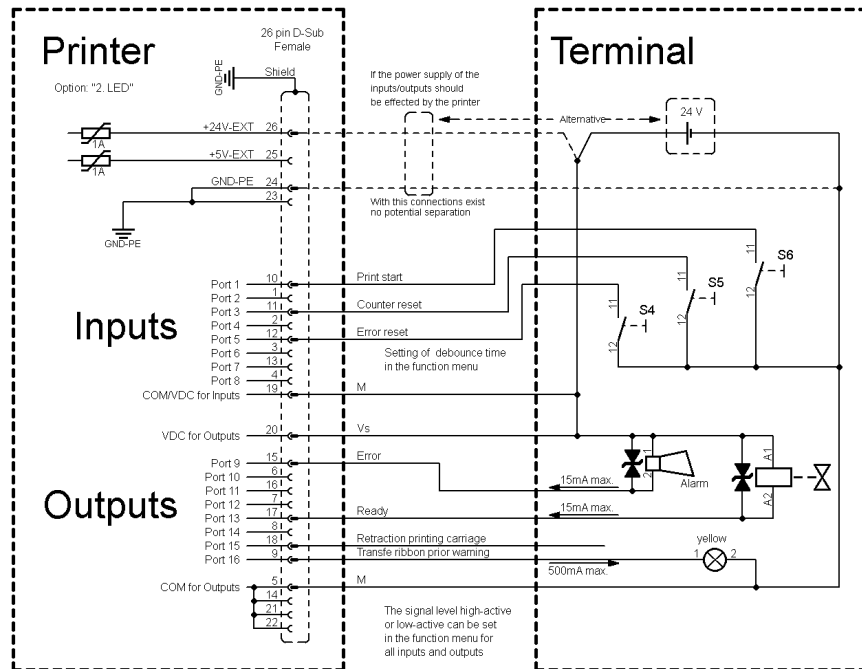
**Figure 25****Precautions**

When connecting a reed contact with a control input, the contact must have a switching capacity of min. 1 A in order to prevent the contact from sticking due to the inrush current. As an alternative, a suitable resistor can be connected in series.

If one of the printer's internal voltages '+5 VDC EXT' or '+24 VDC EXT' is used, an external fuse e.g. 0.5 AF, should be additionally installed to protect the printer electronics.

In the event of an inductive load, an antiparallel connected diode, for instance, must be used to discharge the induction energy.

In order to minimise the influence of leakage currents at control outputs, a resistor must, depending on what is connected, be installed in parallel with the load.

In order to avoid any damages to the printing system, the max. output currents must not be exceeded or outputs shorted.



## 10 Connection Plans

## 10.1 Wiring Plan

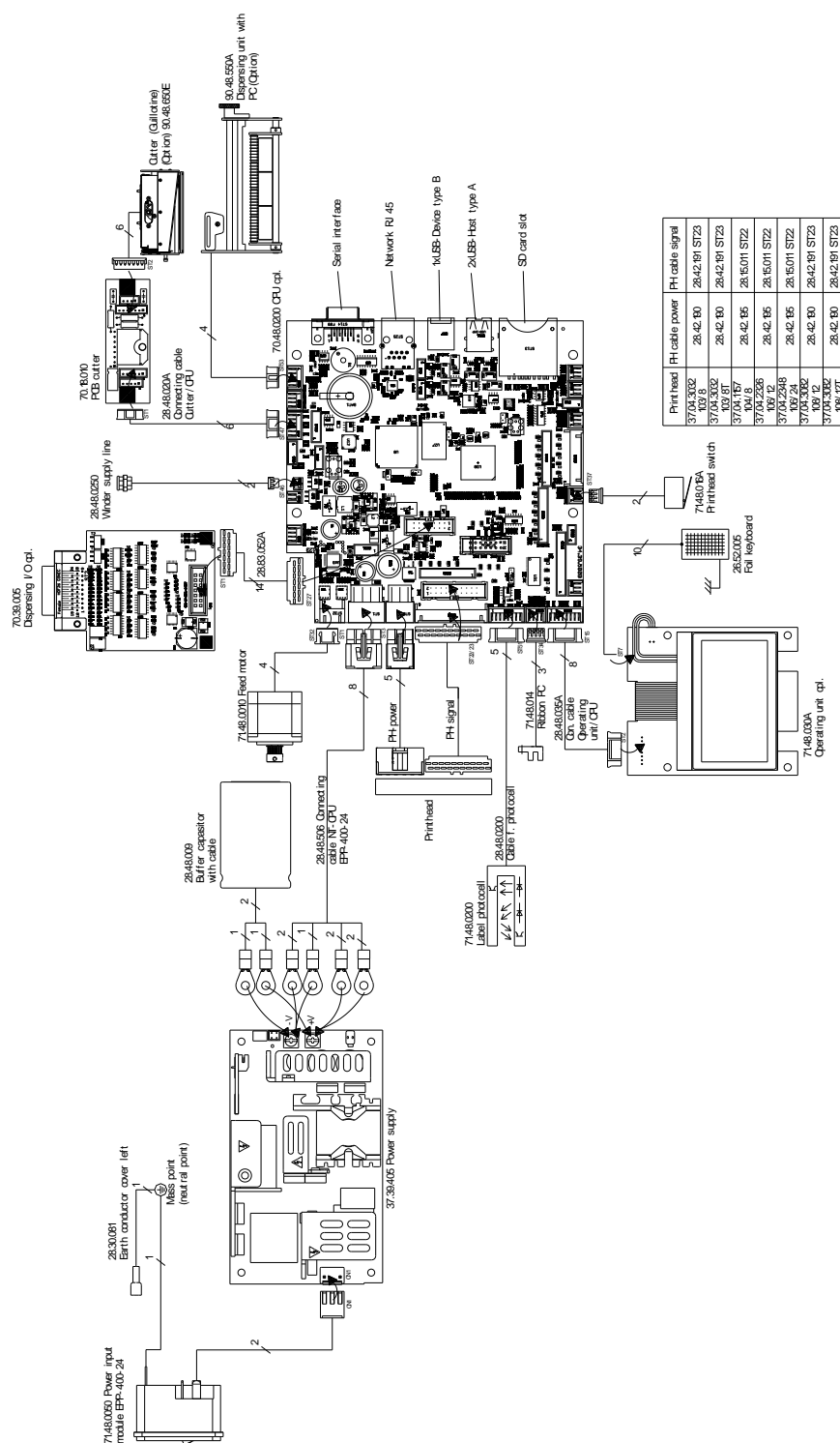

**Figure 26**

10.2 CPU Component Placement Specification

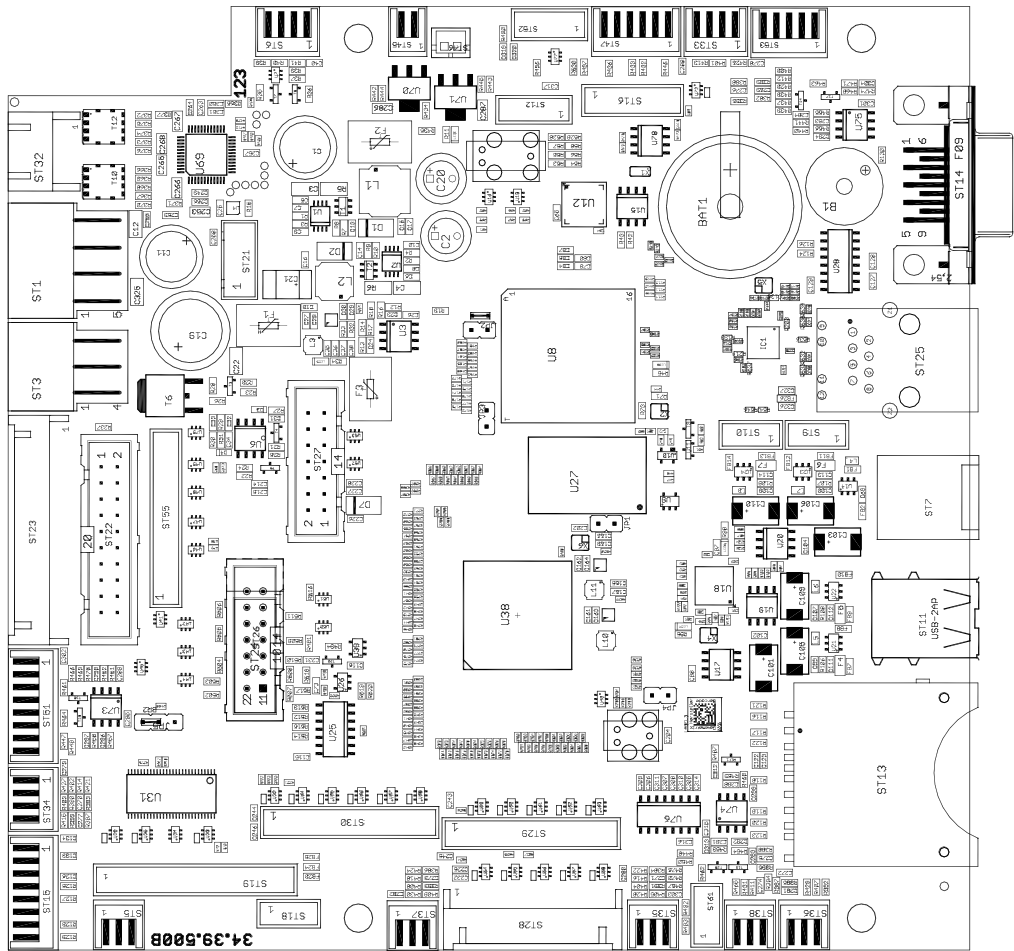
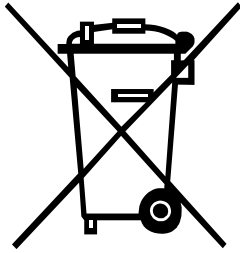

Figure 27

Jumper plan

	JP1 (debug)	JP2 (write-protection)
Boot sector Programming	closed	closed
Delivery	closed	open

## 11 Environmentally-Friendly Disposal



Manufacturers of B2B equipment are obliged to take back and dispose of old equipment that was manufactured after 13 August 2005. As a principle, this old equipment may not be delivered to communal collecting points. It may only be organised, used and disposed of by the manufacturer. Valentin products accordingly labelled can therefore be returned to Carl Valentin GmbH.

This way, you can be sure your old equipment will be disposed of correctly.

Carl Valentin GmbH thereby fulfils all obligations regarding timely disposal of old equipment and facilitates the smooth reselling of these products. Please understand that we can only take back equipment that is sent free of carriage charges.

The electronics board of the printing system is equipped with a battery. This must only be discarded in battery collection containers or by public waste management authorities.

Further information on the WEEE directive is available on our website [www.carl-valentin.de](http://www.carl-valentin.de).



## 12 Index

### A

adjustments, settings, alignments	
head switch .....	34
oil and lubricate .....	35
print mechanism .....	29
printhead position .....	30
rewinder .....	33
transfer ribbon feed path .....	32
unwinder .....	33

### B

battery, replacing .....	27
--------------------------	----

### C

cleaning	
cleaning schedule .....	13
label photocell .....	17
pressure roller .....	15
printhead .....	16
ribbon drawing roller .....	14
component plan CPU .....	60
component replacing	
battery .....	27
CPU PCB .....	25
label photocell .....	24
power supply .....	26
pressure roller .....	23
printhead .....	20, 21
tool list .....	19
connection plans	
wiring plan .....	59
connector pin assignment, printer rear .....	11
control inputs and outputs .....	54, 55
control inputs/control outputs .....	51, 52, 53, 56, 57
CPU	
component plan .....	60
CPU PCB, replacing .....	25
jumper plan .....	60
cutter unit, retrofit .....	39, 40

### D

dispenser unit, retrofit .....	38
--------------------------------	----

### E

electricity, safety handling .....	9, 10
environmentally-friendly disposal .....	61
error messages/error corrections .....	41, 42, 43, 44, 45, 46, 47, 48, 49

### H

head switch, adjusting .....	34
------------------------------	----

### I

I/O plate, retrofit .....	37
instructions .....	5

**J**

jumper plan CPU .....	60
-----------------------	----

**L**

label photocell	
cleaning .....	17
replacing .....	24

**M**

maintenance/cleaning	
printhead adjusting .....	30

**N**

notes	
document .....	5
user .....	5

**O**

oil and lubricate .....	35
-------------------------	----

**P**

power supply, replacing .....	26
pressure roller	
cleaning .....	15
replacing .....	23
print mechanism, adjusting .....	29
print position, adjusting .....	22
printhead	
adjusting .....	30
cleaning .....	16
position, adjusting .....	31
replacing .....	20, 21
printhead adjusting	
parallelism .....	30
pressure .....	31

**R**

retrofit options	
cutter unit .....	39, 40
dispenser unit .....	38
I/O plate .....	37
rewinder, adjusting .....	33
ribbon drawing roller	
cleaning .....	14

**S**

safety handling when working with electricity .....	9, 10
safety instructions .....	8
clothing .....	7
protective clothing .....	7
protective equipment .....	8
workplace .....	7

**T**

tool list .....	19
transfer ribbon feed path, adjusting .....	32



**U**

unwinder, adjusting ..... 33

**W**

wiring plan ..... 59



---

Carl Valentin GmbH  
Neckarstraße 78 – 86 u. 94 . 78056 Villingen-Schwenningen  
Phone +49 7720 9712-0 . Fax +49 7720 9712-9901  
info@carl-valentin.de . [www.carl-valentin.de](http://www.carl-valentin.de)